

## CUMHURBAŞKANI KARARI



**Karar Sayısı: 10778**

Adana, Bingöl, Denizli, Elazığ, Eskişehir, Gümüşhane, Konya, Mersin, Muğla, Trabzon ve Zonguldak illerinde bulunan bazı alanların orman sınırları dışına çıkartılması hakkındaki ekli Kararın yürürlüğe konulmasına, 6831 sayılı Orman Kanununun ek 16 ncı maddesi gereğince karar verilmiştir.

24 Aralık 2025

**Recep Tayyip ERDOĞAN**  
CUMHURBAŞKANI

**24/12/2025 TARİHLİ VE 10778 SAYILI CUMHURBAŞKANI KARARININ EKİ**  
**KARAR**

**Orman sınırı dışına çıkartılan alanlar**

**MADDE 1-** (1) Adana, Bingöl, Denizli, Elazığ, Eskişehir, Gümüşhane, Konya, Mersin, Muğla, Trabzon ve Zonguldak illerinde bulunan ve ekli krokiler ile listelerde sınır ve koordinatları gösterilen alanların orman sınırları dışına çıkartılmasına karar verilmiştir.

(2) Birinci fıkra kapsamında orman sınırları dışına çıkartılan alanların iki katundan az olmamak üzere Devletin hüküm ve tasarrufu altında veya Hazinesinin özel mülkiyetinde bulunan taşınmazlardan Çevre, Şehircilik ve İklim Değişikliği Bakanlığı (Milli Emlak Genel Müdürlüğü) tarafından Orman Genel Müdürlüğüne orman tesis etmek üzere tahsis yapılır.

**Yürürlük**

**MADDE 2-** (1) Bu Karar yayımı tarihinde yürürlüğe girer.

**Yürütme**

**MADDE 3-** (1) Bu Karar hükümlerini Cumhurbaşkanı yürütür.

### RÖLEVE KROKİSİ

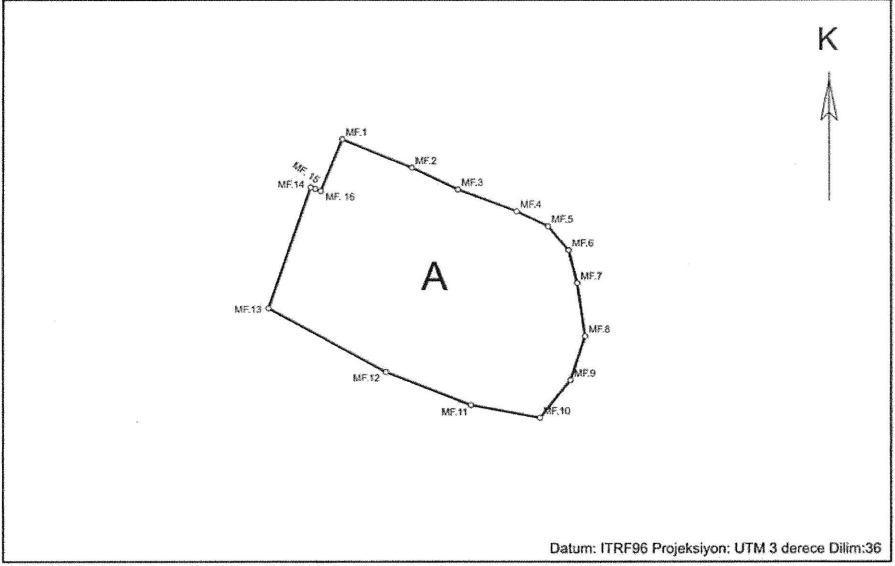

Ada	Parsel	Noktalar	HesapAlan
0_612	A	MF.1,MF.2,MF.3,MF.4,MF.5,MF.6, MF.7,MF.8,MF.9,MF.10,MF.11, MF.12,MF.13,MF.14,MF. 15, MF. 16	1102.21

NoktaNo	Y	X	NoktaNo	Y	X
MF.1	456846.87	4109692.11	MF.2	456856.63	4109688.10
MF.3	456863.11	4109685.03	MF.4	456871.35	4109681.96
MF.5	456875.82	4109679.91	MF.6	456878.68	4109676.56
MF.7	456879.88	4109671.91	MF.8	456880.99	4109664.41
MF.9	456878.95	4109658.27	MF.10	456874.65	4109652.96
MF.11	456864.92	4109654.77	MF.12	456853.04	4109659.41
MF.13	456836.34	4109668.34	MF.14	456842.34	4109685.31
MF. 15	456842.97	4109685.10	MF. 16	456843.76	4109684.79

RÖLEVE KROKİSİ

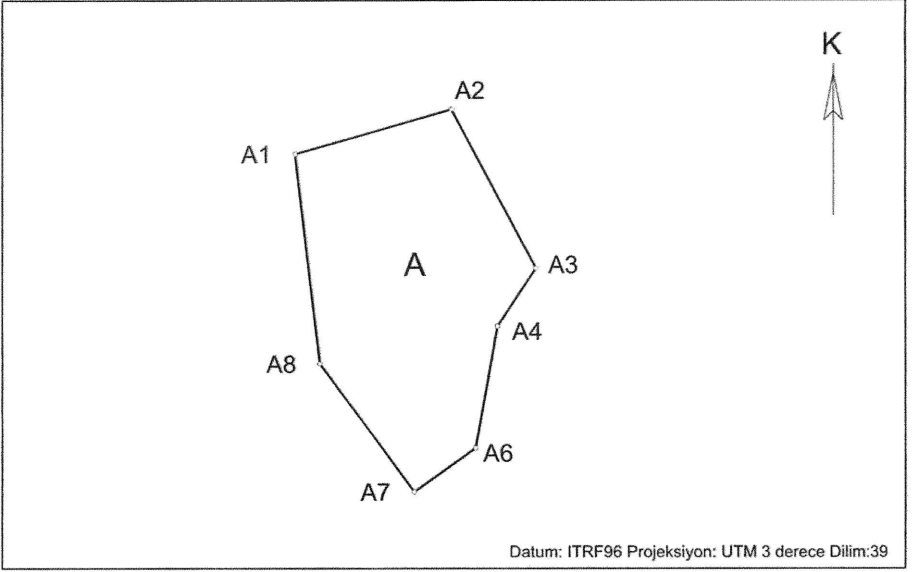

Ada	Parsel	Noktalar	HesapAlan
104	14_15-A	A1,A2,A3,A4,A6,A7,A8	425.23

NoktaNo	Y	X	NoktaNo	Y	X
A1	624394.12	4305569.32	A2	624407.37	4305573.14
A3	624414.53	4305559.62	A4	624411.28	4305554.70
A6	624409.46	4305544.30	A7	624404.22	4305540.59
A8	624396.24	4305551.51			

İli : DENİZLİ  
İlçesi : BULDAN  
Mahallesi : YENİ

### RÖLEVE KROKİSİ

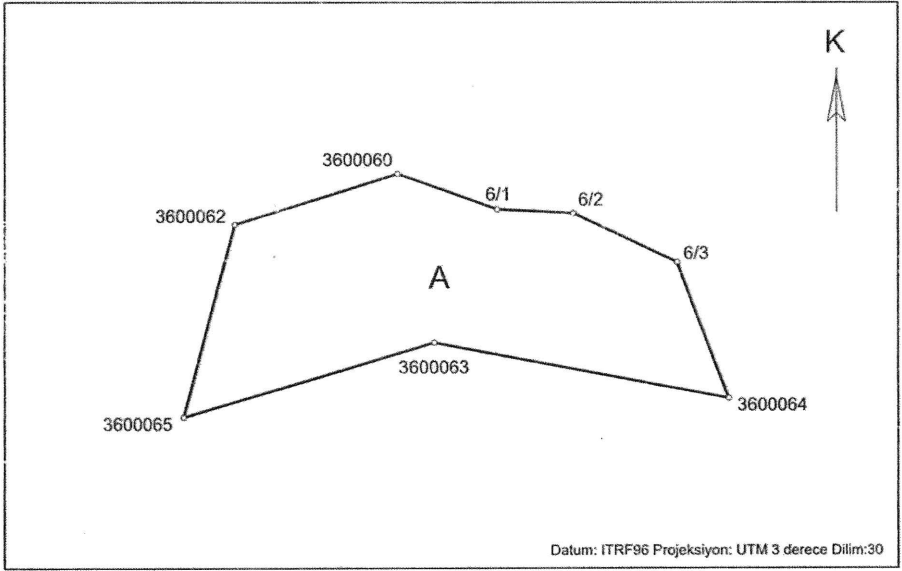

Ada	Parsel	Noktalar	HesapAlan
360	6-A	3600064,3600063,3600065, 3600062,3600060,6/1,6/2,6/3	4150.45

NoktaNo	Y	X	NoktaNo	Y	X
6/1	399224.36	4213731.76	6/2	399241.80	4213730.88
6/3	399265.79	4213719.54	3600060	399201.41	4213739.83
3600062	399163.98	4213728.25	3600063	399209.78	4213701.12
3600064	399277.58	4213688.35	3600065	399152.23	4213683.98

Bölge Müdürlüğü : Denizli Orman Bölge Müdürlüğü  
İşletme Müdürlüğü : Çal Orman İşletme Müdürlüğü  
İşletme Şefliği : Çardak Orman İşletme Şefliği  
Datum : ITRF96

İli : Denizli  
İlçesi : Çardak  
Köyü /Mahallesi : Hürriyet  
Dilim : 3\_30

### RÖLEVE ÖLÇÜ KROKİSİ

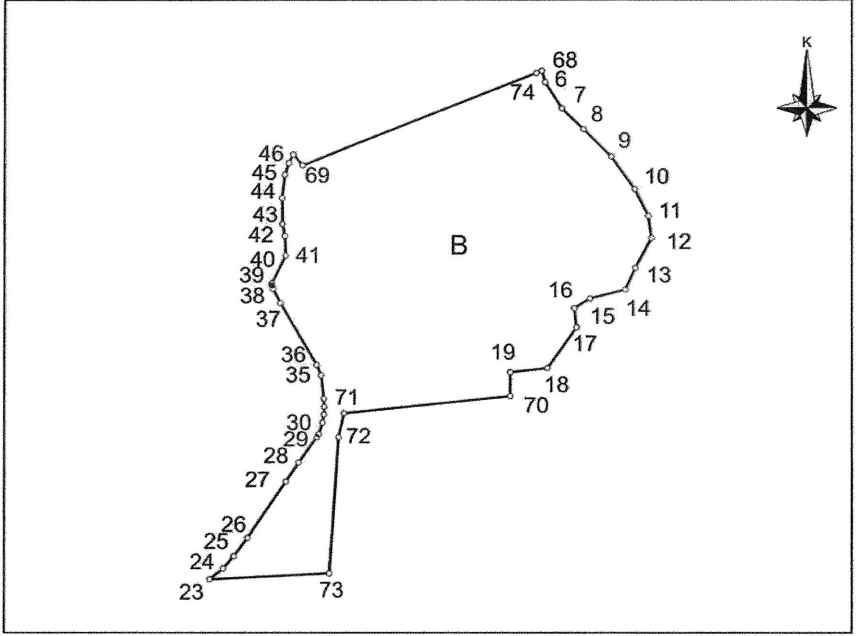

Ada	Parsel	Noktalar	HesapAlan
195	1-B	47,69,74,68,6,7,8,9,10,11,12, 13,14,15,16,17,18,19,70,71,72, 73,23,24,25,26,27,28,29,30,31, 32,33,34,35,36,37,38,39,40,41, 42,43,44,45,46	151938.83

NoktaNo	Y	X	NoktaNo	Y	X
6	473971.06	4188529.23	7	473991.23	4188496.10
8	474018.15	4188469.59	9	474052.65	4188434.82
10	474081.04	4188392.99	11	474097.47	4188358.51
12	474101.20	4188330.41	13	474081.63	4188292.71
14	474069.53	4188265.08	15	474026.26	4188253.93
16	474006.73	4188241.65	17	474009.67	4188217.86
18	473973.82	4188166.29	19	473928.94	4188161.13
23	473558.85	4187898.54	24	473575.50	4187912.07
25	473588.73	4187927.69	26	473605.38	4187950.64
27	473652.44	4188021.65	28	473668.25	4188045.77
29	473690.73	4188078.67	30	473692.97	4188082.48
31	473697.89	4188097.34	32	473699.55	4188107.45
33	473699.90	4188117.52	34	473699.44	4188127.60
35	473695.92	4188157.27	36	473690.42	4188170.53
37	473645.75	4188248.51	38	473636.70	4188266.28
39	473634.93	4188270.94	40	473635.12	4188273.22
41	473652.01	4188308.69	42	473651.03	4188333.31
43	473648.07	4188348.51	44	473647.75	4188381.96
45	473651.09	4188412.20	46	473656.05	4188427.26
47	473661.38	4188438.01	68	473967.02	4188543.74
69	473672.76	4188424.10	70	473929.01	4188130.91
71	473724.79	4188109.00	72	473717.90	4188078.95
73	473706.41	4187905.98	74	473960.58	4188540.88

İli : ELAZIĞ  
İlçesi : BASKİL  
Köy/Mahalle : KARAALI

## RÖLEVE KROKİSİ

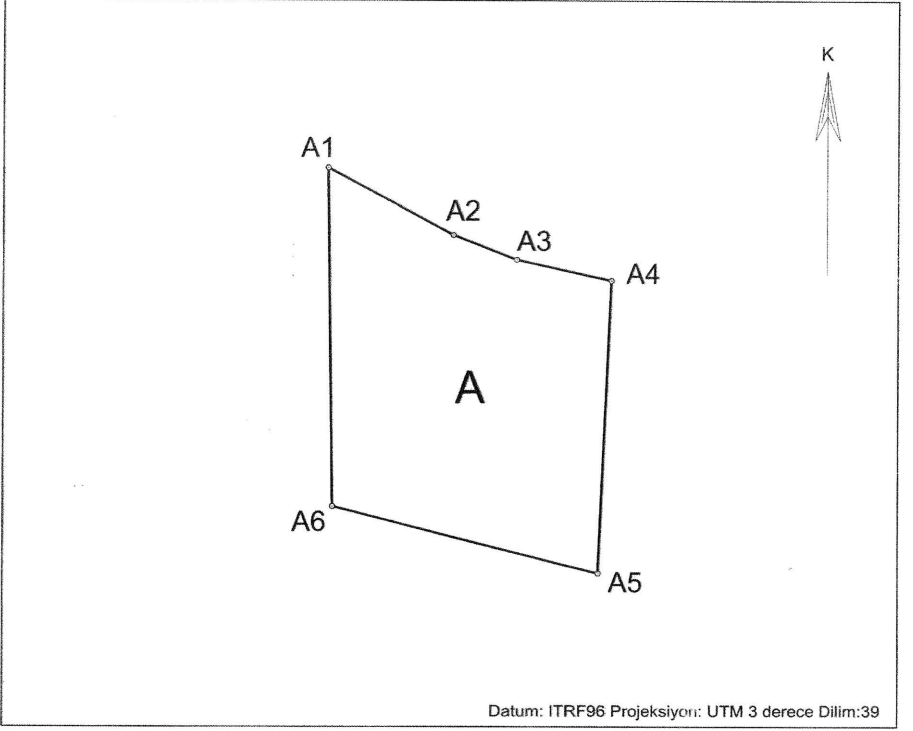

Ada	Parsel	Noktalar	HesapAlan
143	72-A	A6,A1,A2,A3,A4,A5	1271.22

NoktaNo	Y	X	NoktaNo	Y	X
A1	491816.23	4259152.63	A2	491831.75	4259144.44
A3	491839.50	4259141.43	A4	491851.10	4259138.90
A5	491849.55	4259102.88	A6	491816.87	4259111.08

İli : ELAZIĞ  
İlçesi : BASKIL  
Köy/Mahalle : KARAALI

## RÖLEVE KROKİSİ

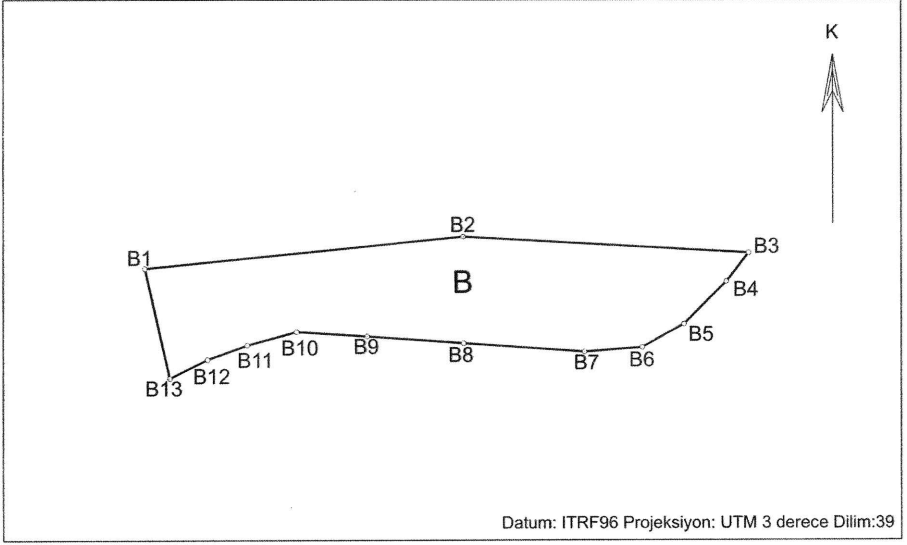

Datum: ITRF96 Projeksiyon: UTM 3 derece Dilim:39

Ada	Parsel	Noktalar	HesapAlan
143	B	B8,B9,B10,B11,B12,B13,B1,B2, B3,B4,B5,B6,B7	2128.83

NoktaNo	Y	X	NoktaNo	Y	X
B1	491710.58	4259198.12	B2	491773.88	4259204.40
B3	491830.90	4259201.17	B4	491826.46	4259195.46
B5	491817.98	4259187.02	B6	491809.63	4259182.41
B7	491798.19	4259181.53	B8	491773.98	4259183.24
B9	491754.66	4259184.61	B10	491740.59	4259185.48
B11	491730.91	4259182.85	B12	491723.00	4259179.99
B13	491715.52	4259176.25			

RÖLEVE KROKİSİ

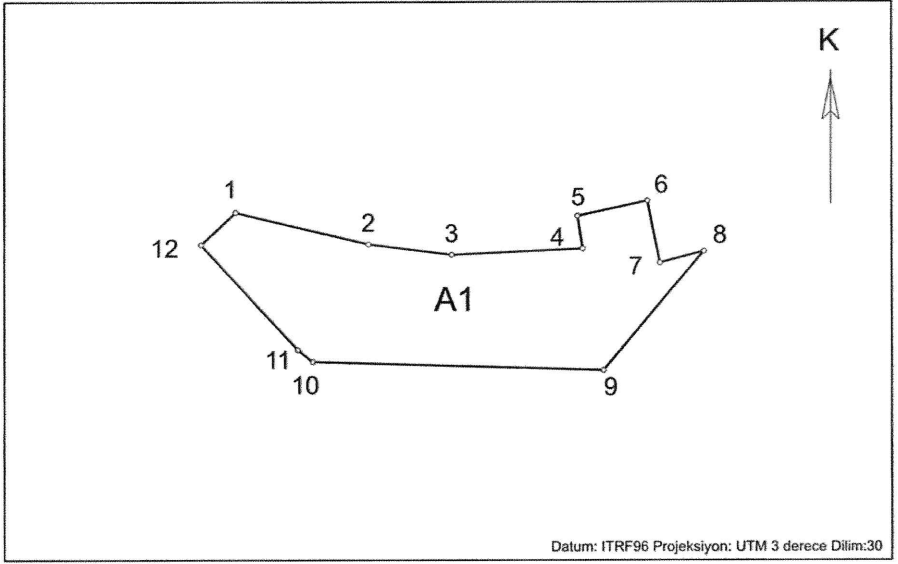

Ada	Parsel	Noktalar	HesapAlan
(1366/1)	A1	9,10,11,12,1,2,3,4,5,6,7,8	1416.26

NoktaNo	Y	X	NoktaNo	Y	X
1	590206.70	4423653.86	2	590228.55	4423648.61
3	590242.25	4423646.85	4	590263.76	4423647.85
5	590262.90	4423653.24	6	590274.43	4423655.73
7	590276.48	4423645.50	8	590283.70	4423647.39
9	590267.13	4423627.77	10	590219.37	4423629.19
11	590216.93	4423631.16	12	590200.99	4423648.53

RÖLEVE KROKİSİ

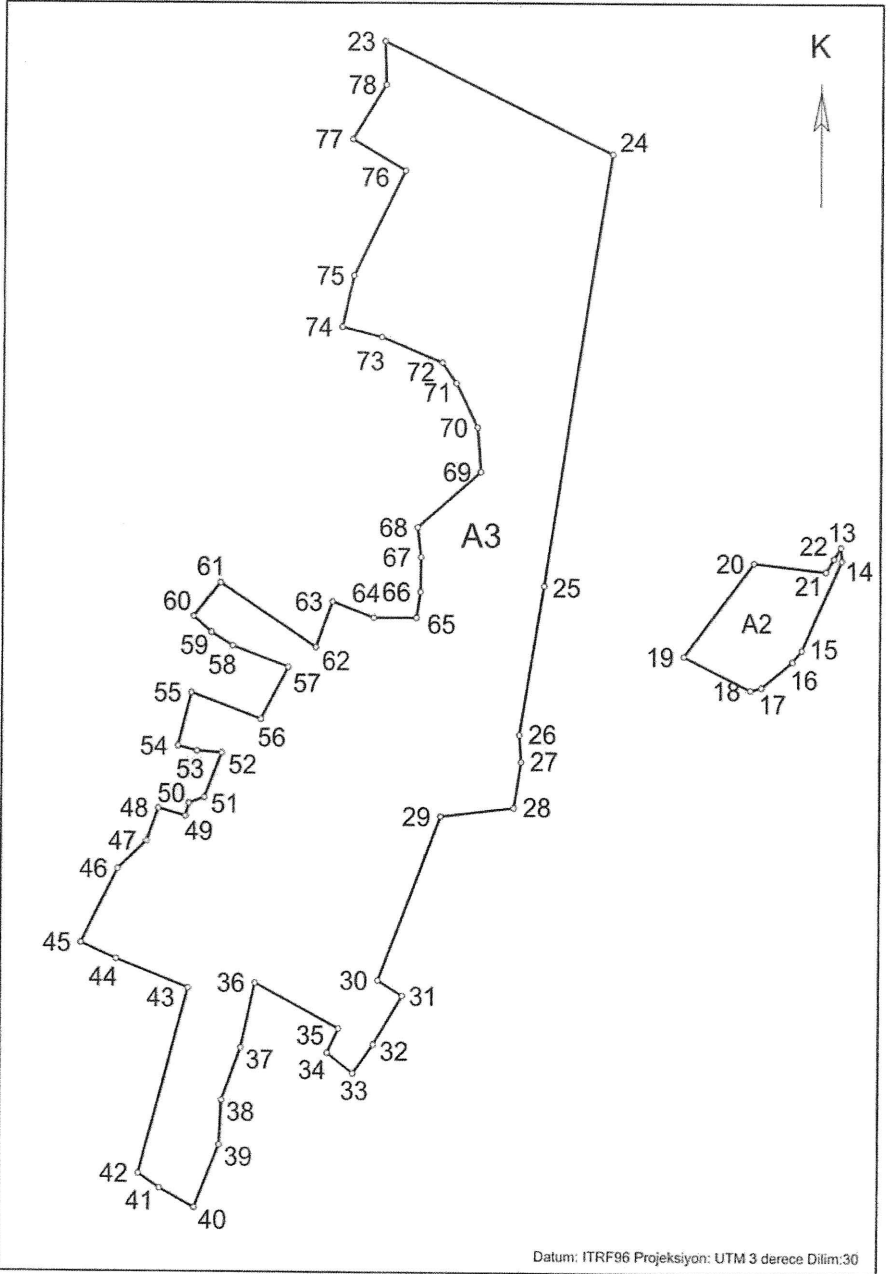

İli  
İlçesi  
Mahallesi

ESKİŞEHİR  
ALPU  
ARIKAYA

KOORDİNE ÖZETLİ ALAN HESABI ÇİZELGESİ

Ada	Parsel	Noktalar	HesapAlan
(1366/1)	A2	13,14,15,16,17,18,19,20,21,22	515.87
(1366/1)	A3	29,30,31,32,33,34,35,36,37,38, 39,40,41,42,43,44,45,46,47,48, 49,50,51,52,53,54,55,56,57,58, 59,60,61,62,63,64,65,66,67,68, 69,70,71,72,73,74,75,76,77,78, 23,24,25,26,27,28	9925.17

Datum: ITRF96 Projeksiyon: UTM 3 derece Dilim:30

NoktaNo	Y	X	NoktaNo	Y	X
13	590322.33	4423314.27	14	590322.57	4423311.45
15	590313.87	4423292.79	16	590311.78	4423290.43
17	590304.90	4423285.02	18	590302.48	4423284.42
19	590287.86	4423291.40	20	590303.15	4423310.92
21	590319.09	4423309.13	22	590320.84	4423311.91
23	590222.01	4423420.05	24	590271.67	4423396.59
25	590257.30	4423305.98	26	590252.09	4423275.00
27	590252.51	4423269.33	28	590250.99	4423259.81
29	590234.98	4423257.98	30	590221.62	4423223.82
31	590226.90	4423220.62	32	590220.68	4423210.48
33	590216.27	4423204.45	34	590210.59	4423208.73
35	590213.09	4423213.74	36	590194.59	4423223.24
37	590191.57	4423209.71	38	590187.40	4423198.76
39	590186.95	4423189.30	40	590181.58	4423176.23
41	590173.89	4423180.21	42	590169.24	4423183.28
43	590179.95	4423222.13	44	590164.15	4423228.12
45	590156.44	4423231.48	46	590164.39	4423246.86
47	590170.66	4423252.69	48	590173.19	4423259.53
49	590179.15	4423257.91	50	590179.92	4423260.58
51	590183.27	4423261.77	52	590187.01	4423271.06
53	590181.62	4423271.45	54	590177.42	4423272.47
55	590180.33	4423283.61	56	590195.57	4423278.14
57	590201.56	4423289.00	58	590189.29	4423293.31
59	590184.61	4423296.11	60	590180.68	4423299.45
61	590186.51	4423306.49	62	590207.58	4423293.08
63	590211.23	4423302.61	64	590220.25	4423299.23
65	590229.49	4423299.23	66	590230.35	4423304.69
67	590230.44	4423311.95	68	590229.64	4423318.28
69	590243.40	4423329.99	70	590242.63	4423339.26
71	590237.94	4423348.45	72	590234.80	4423352.75
73	590221.68	4423358.01	74	590213.03	4423360.10
75	590215.55	4423370.96	76	590226.58	4423393.08
77	590215.09	4423399.66	78	590222.31	4423411.02

## RÖLEVE KROKİSİ

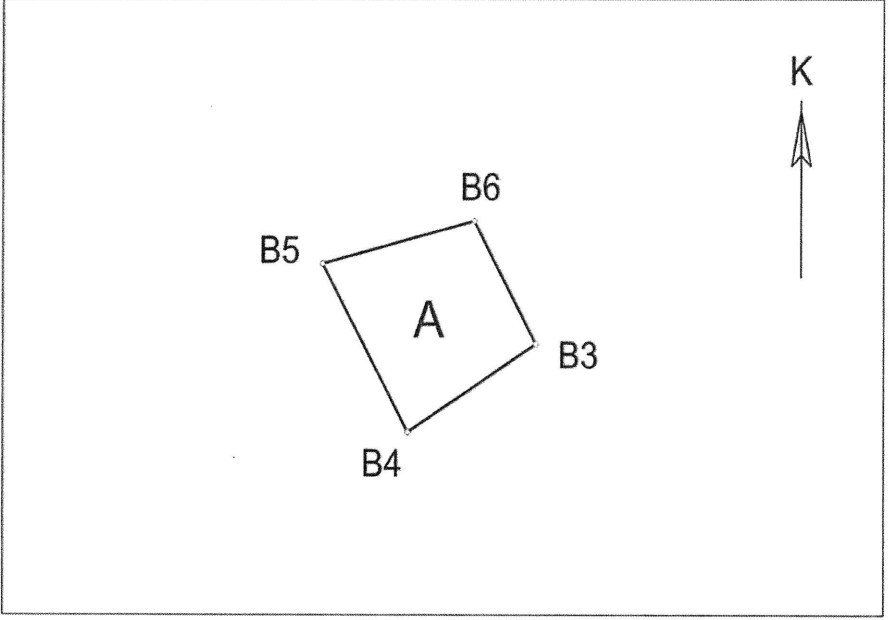

Ada	Parsel	Noktalar	HesapAlan
145	153-A	B3,B4,B5,B6	86.95

NoktaNo	Y	X	NoktaNo	Y	X
B3	530028.51	4487087.95	B6	530024.67	4487094.73
B4	530020.53	4487083.07	B5	530015.19	4487092.39

RÖLEVE KROKİSİ

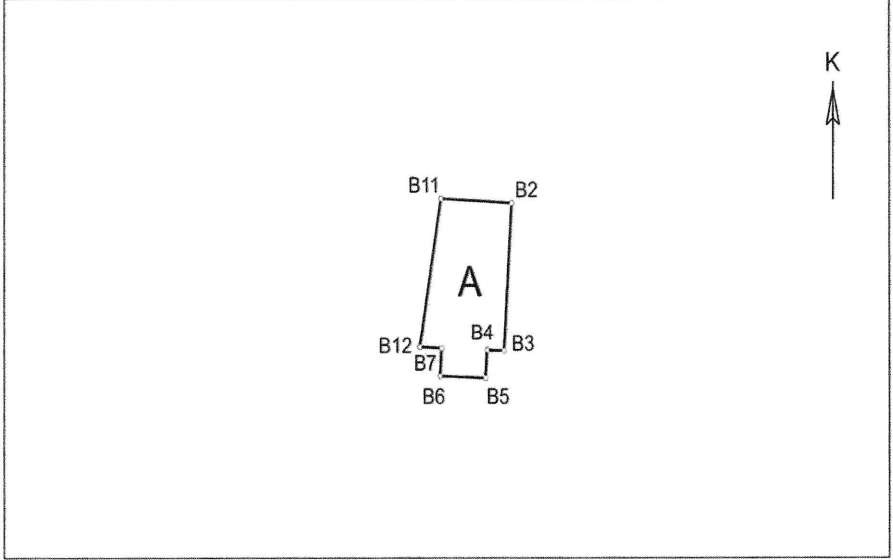

Ada	Parsel	Noktalar	HesapAlan
101	393-A	B11,B2,B3,B4,B5,B6,B7,B12	103.82

NoktaNo	Y	X	NoktaNo	Y	X
B2	526792.76	4490653.82	B3	526792.02	4490641.56
B4	526790.35	4490641.61	B5	526790.19	4490639.29
B7	526785.93	4490641.77	B11	526785.86	4490654.21
B6	526785.79	4490639.45	B12	526783.80	4490641.89

İli  
İlçesi  
Mahallesi

KONYA  
SELÇUKLU  
AKPINAR

### RÖLEVE KROKİSİ

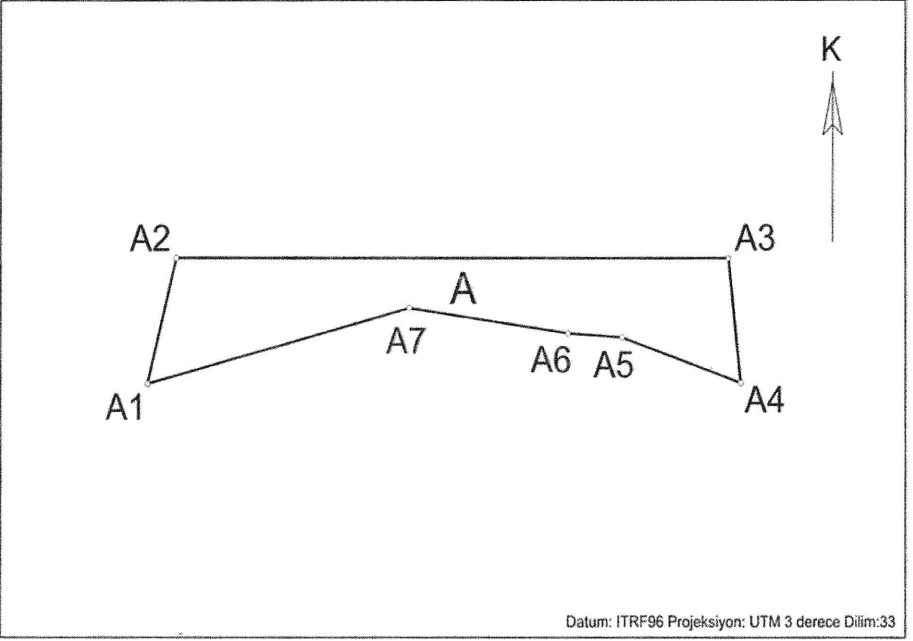

Ada	Parsel	Noktalar	HesapAlan
194	232-A	A1,A2,A3,A4,A5,A6,A7	457.61

NoktaNo	Y	X	NoktaNo	Y	X
A1	429593.09	4202787.24	A2	429596.09	4202799.05
A3	429653.73	4202798.97	A4	429655.01	4202787.29
A5	429642.60	4202791.54	A6	429637.00	4202791.92
A7	429620.45	4202794.31			

RÖLEVE KROKİSİ

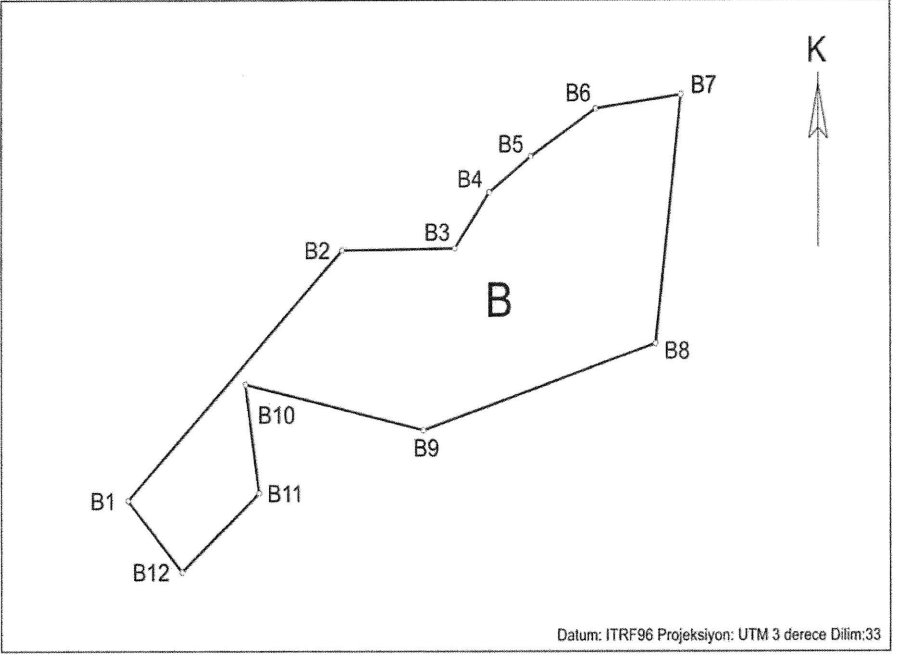

Ada	Parsel	Noktalar	HesapAlan
194	232-B	B1,B2,B3,B4,B5,B6,B7,B8,B9, B10,B11,B12	2169.69

NoktaNo	Y	X	NoktaNo	Y	X
B1	429486.04	4202621.35	B2	429521.62	4202657.17
B3	429540.27	4202657.43	B4	429545.99	4202665.48
B5	429552.93	4202670.61	B6	429563.83	4202677.44
B7	429577.85	4202679.40	B8	429573.66	4202643.71
B9	429535.07	4202631.47	B10	429505.51	4202638.02
B11	429507.78	4202622.41	B12	429495.03	4202611.05

RÖLEVE KROKİSİ

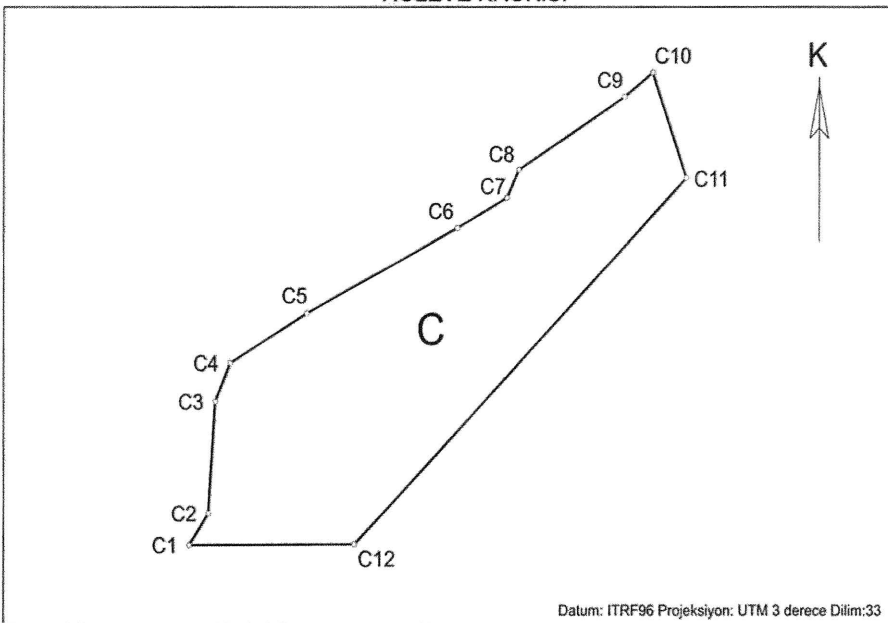

Datum: ITRF96 Projeksiyon: UTM 3 derece Dilim:33

Ada	Parsel	Noktalar	HesapAlan
194	232-C	C1,C2,C3,C4,C5,C6,C7,C8,C9, C10,C11,C12	2461.40

NoktaNo	Y	X	NoktaNo	Y	X
C1	429211.00	4202458.67	C2	429214.32	4202463.66
C3	429215.53	4202481.23	C4	429218.16	4202487.30
C5	429231.48	4202495.10	C6	429257.37	4202508.43
C7	429265.91	4202513.13	C8	429267.97	4202517.48
C9	429286.21	4202529.03	C10	429291.03	4202532.88
C11	429296.85	4202516.21	C12	429239.67	4202458.81

RÖLEVE KROKİSİ

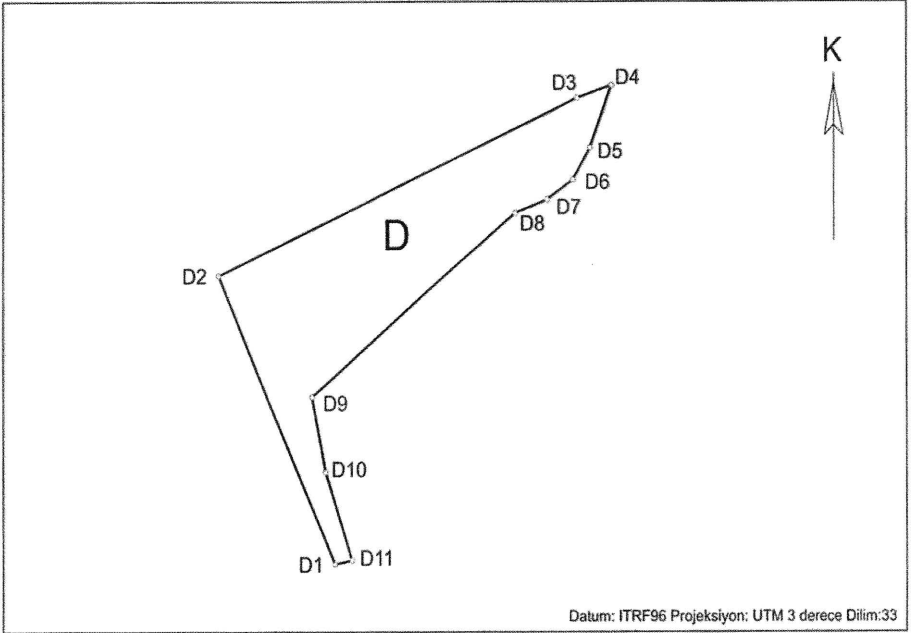

Datum: ITRF96 Projeksiyon: UTM 3 derece Dilim:33

Ada	Parsel	Noktalar	HesapAlan
194	232-D	D1,D2,D3,D4,D5,D6,D7,D8,D9, D10,D11	1360.58

NoktaNo	Y	X	NoktaNo	Y	X
D1	428838.72	4202426.57	D2	428818.06	4202473.02
D3	428881.81	4202501.72	D4	428887.95	4202503.78
D5	428884.11	4202493.72	D6	428881.07	4202488.52
D7	428876.46	4202485.36	D8	428870.87	4202483.17
D9	428834.64	4202453.62	D10	428837.06	4202441.47
D11	428841.78	4202427.24			

RÖLEVE KROKİSİ

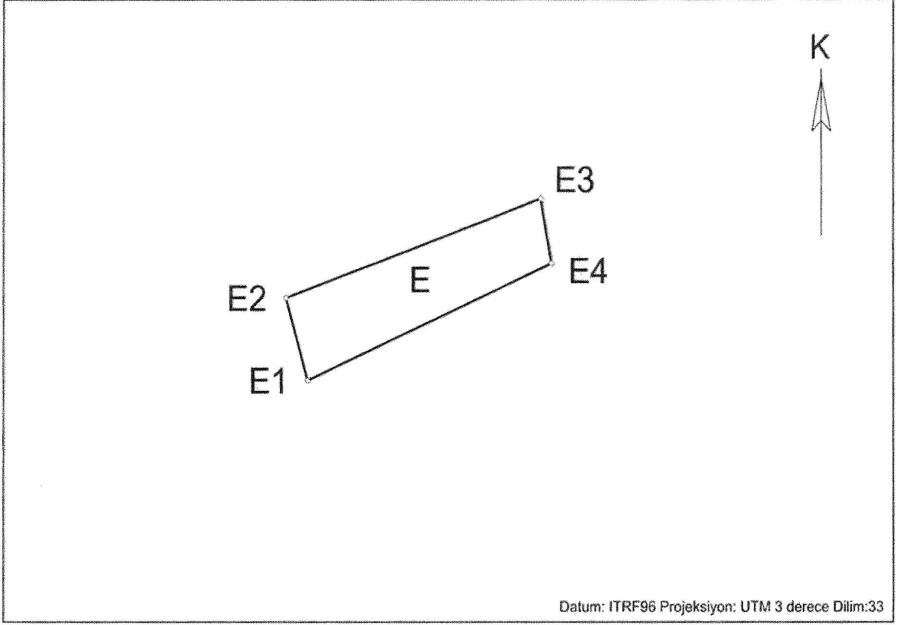

Ada	Parsel	Noktalar	HesapAlan
194	232-E	E1,E2,E3,E4	205.71

NoktaNo	Y	X	NoktaNo	Y	X
E1	428928.11	4202653.29	E2	428925.79	4202661.20
E3	428952.86	4202670.75	E4	428954.01	4202664.50

RÖLEVE KROKİSİ

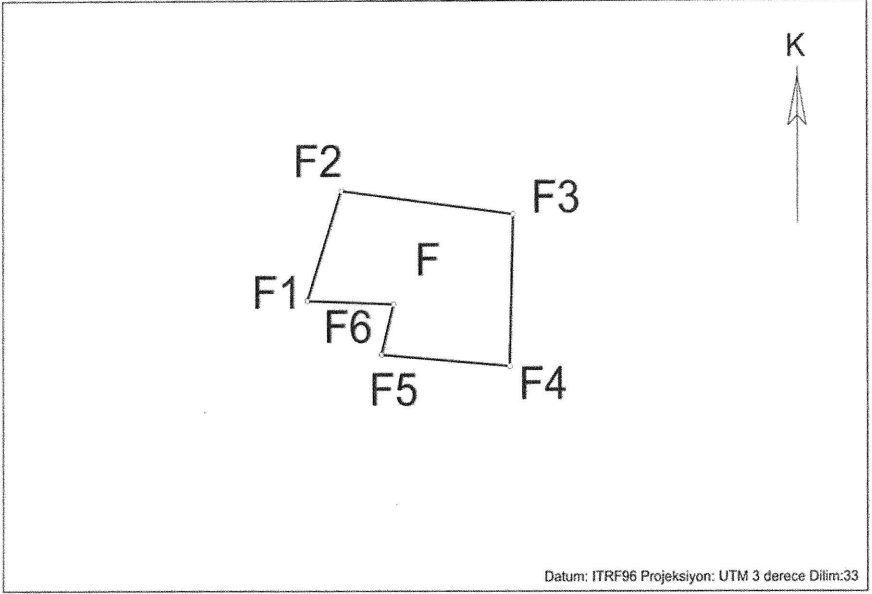

Datum: ITRF96 Projeksiyon: UTM 3 derece Dilim:33

Ada	Parsel	Noktalar	HesapAlan
194	232-F	F1,F2,F3,F4,F5,F6	164.24

NoktaNo	Y	X	NoktaNo	Y	X
F1	428455.52	4202635.36	F2	428458.31	4202643.74
F3	428472.48	4202641.93	F4	428472.20	4202630.37
F5	428461.63	4202631.26	F6	428462.63	4202635.09

İli  
İlçesi  
Mahallesi

KONYA  
SELÇUKLU  
AKPINAR

### RÖLEVE KROKİSİ

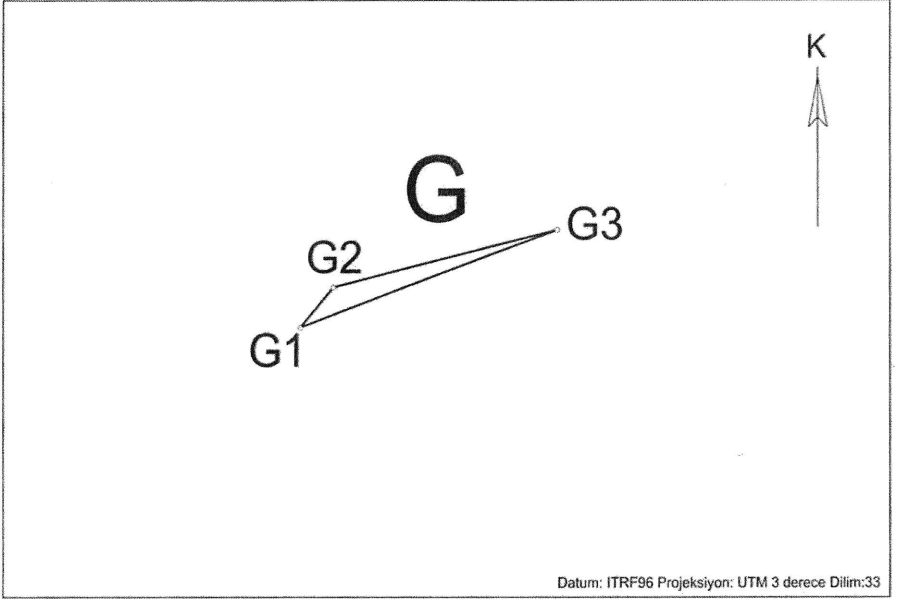

Ada	Parsel	Noktalar	HesapAlan
194	232-G	G1,G2,G3	21.27

NoktaNo	Y	X	NoktaNo	Y	X
G1	428027.24	4202611.11	G2	428029.93	4202614.13
G3	428047.90	4202618.50			

RÖLEVE KROKİSİ

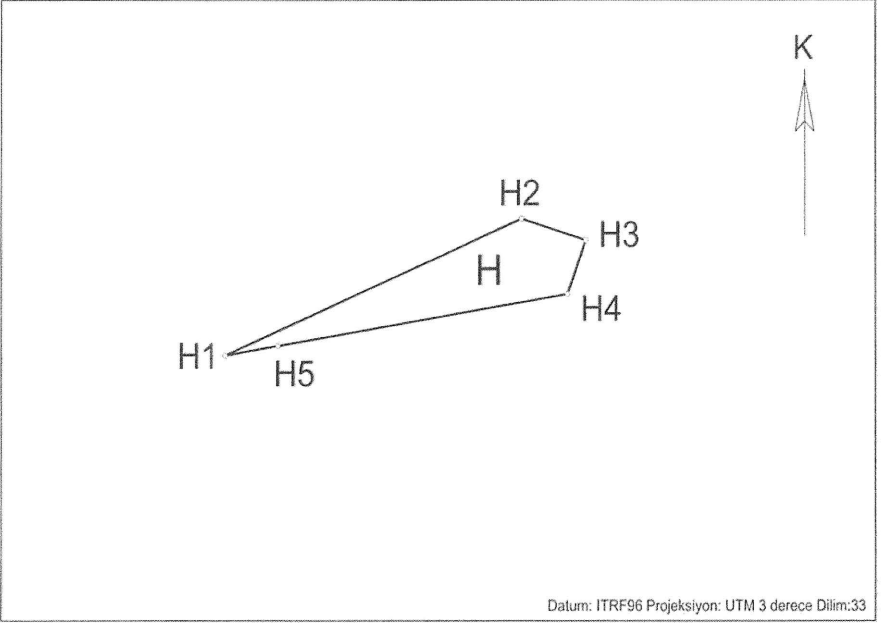

Ada	Parsel	Noktalar	HesapAlan
194	232-H	H1,H2,H3,H4,H5	169.60

NoktaNo	Y	X	NoktaNo	Y	X
H1	427785.04	4202552.31	H2	427817.12	4202565.50
H3	427824.02	4202563.45	H4	427822.08	4202558.20
H5	427790.76	4202553.24			

RÖLEVE KROKİSİ

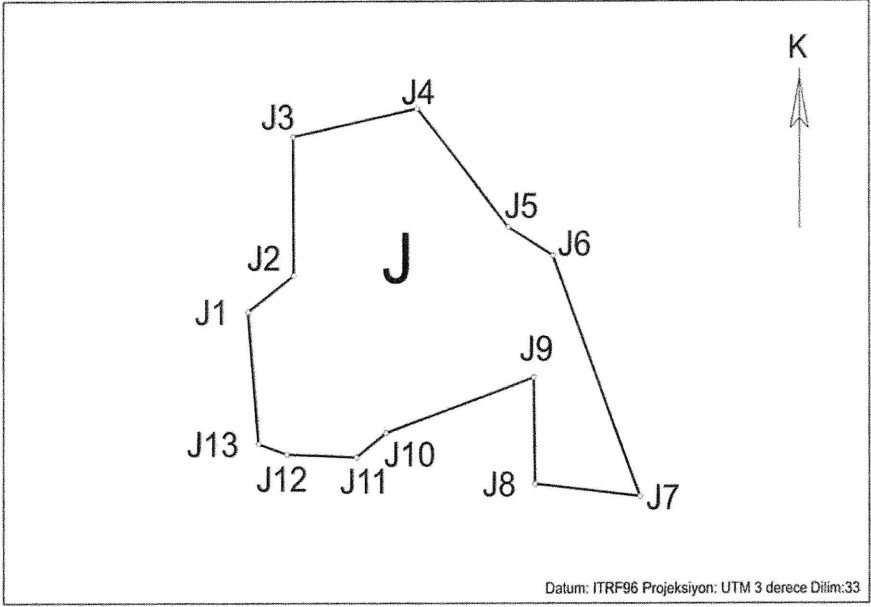

Ada	Parsel	Noktalar	HesapAlan
167	285-J	J1,J2,J3,J4,J5,J6,J7,J8,J9, J10,J11,J12,J13	931.00

NoktaNo	Y	X	NoktaNo	Y	X
J1	426858.15	4200511.03	J2	426863.17	4200514.58
J3	426863.09	4200528.34	J4	426876.63	4200531.14
J5	426886.57	4200519.33	J6	426891.45	4200516.52
J7	426900.98	4200492.69	J8	426889.47	4200493.93
J9	426889.34	4200504.50	J10	426873.21	4200499.02
J11	426870.00	4200496.59	J12	426862.41	4200496.90
J13	426859.28	4200497.94			

RÖLEVE KROKİSİ

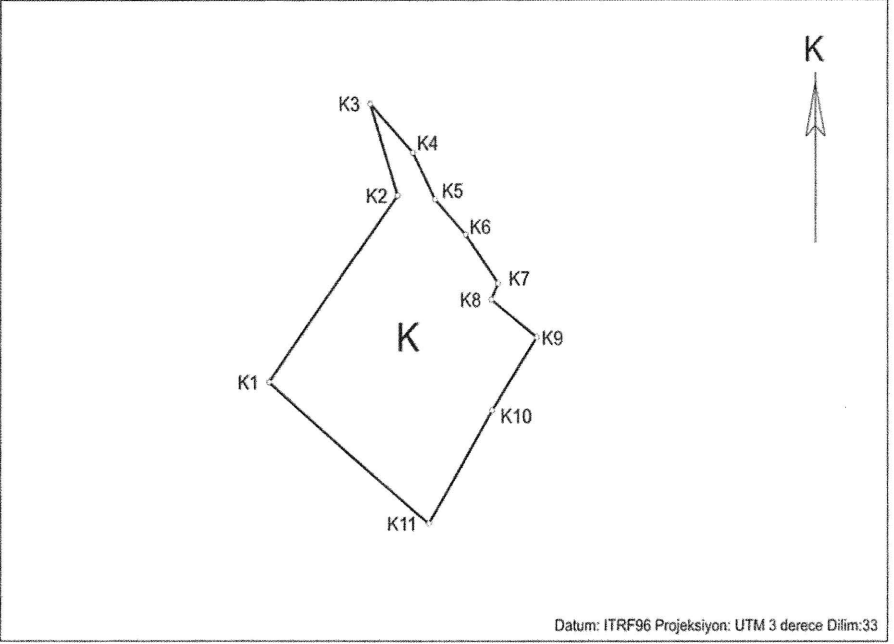

Ada	Parsel	Noktalar	HesapAlan
167	285-K	K1,K2,K3,K4,K5,K6,K7,K8,K9, K10,K11	1691.41

NoktaNo	Y	X	NoktaNo	Y	X
K1	428083.75	4200017.43	K2	428109.34	4200049.95
K3	428103.90	4200065.91	K4	428112.34	4200057.45
K5	428116.74	4200049.29	K6	428122.90	4200043.13
K7	428129.43	4200034.53	K8	428128.06	4200031.69
K9	428137.10	4200025.19	K10	428128.28	4200012.55
K11	428115.52	4199992.70			

RÖLEVE KROKİSİ

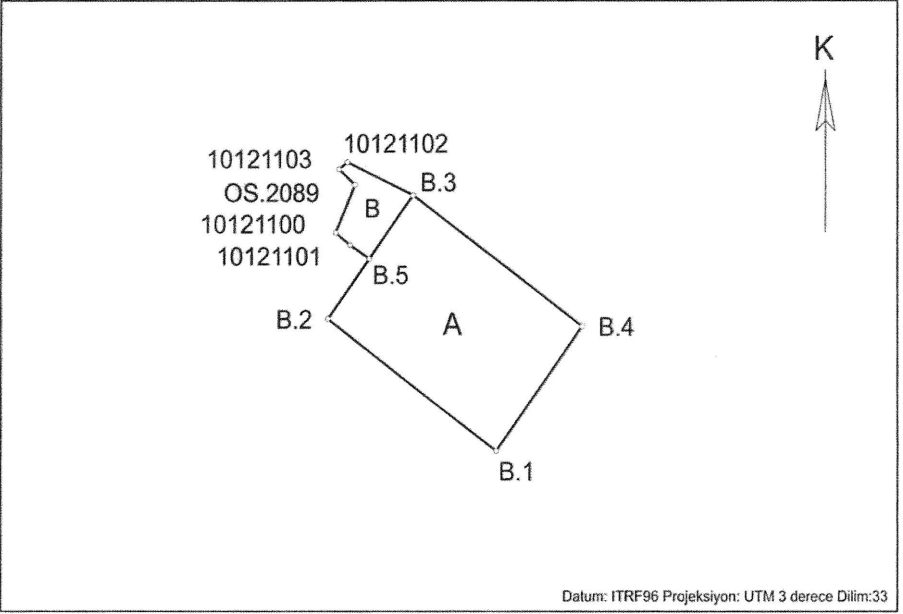

Datum: ITRF96 Projeksiyon: UTM 3 derece Dilim:33

Ada	Parsel	Noktalar	HesapAlan
101	2705-A	B.1,B.2,B.5,B.3,B.4	154.47
101	2705-B	B.3,B.5,10121101,10121100, OS.2089,10121103,10121102	18.87

NoktaNo	Y	X	NoktaNo	Y	X
10121100	524392.05	4083980.02	10121101	524393.07	4083979.21
10121102	524392.87	4083984.76	10121103	524392.28	4083984.28
B.1	524403.61	4083965.49	B.2	524391.49	4083974.27
B.3	524397.64	4083982.56	B.4	524409.76	4083973.78
B.5	524394.47	4083978.29	OS.2089	524393.42	4083983.25

RÖLEVE KROKİSİ

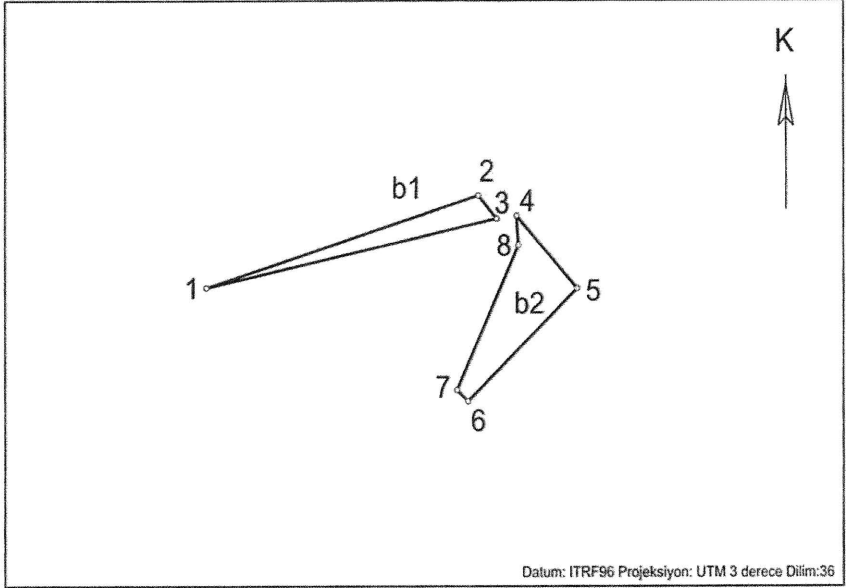

Ada	Parsel	Noktalar	HesapAlan
0_3048	B1	2,3,1	332.68
0_3048	B2	8,4,5,6,7	644.05

NoktaNo	Y	X	NoktaNo	Y	X
1	365745.01	4076643.80	2	365827.34	4076669.13
3	365833.01	4076662.79	4	365839.12	4076663.55
5	365857.74	4076643.46	6	365824.29	4076612.57
7	365820.96	4076615.63	8	365839.72	4076655.54

### RÖLEVE KROKİSİ

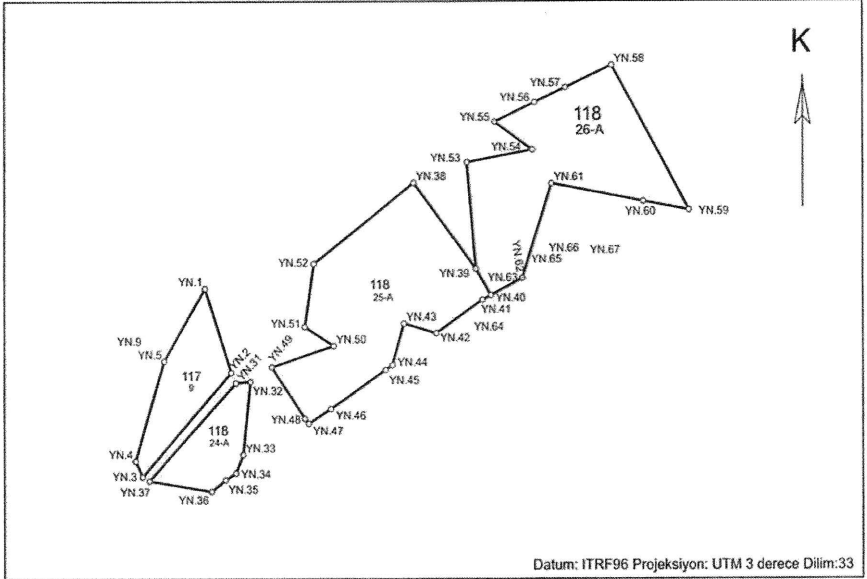

Datum: ITRF96 Projeksiyon: UTM 3 derece Dilim:33

Ada	Parsel	Noktalar	HesapAlan
117	9	YN.2,YN.3,YN.4,YN.5,YN.1	4136.84
118	24-A	YN.36,YN.37,YN.31,YN.32,YN.33, YN.34,YN.35	3089.71
118	25-A	YN.42,YN.43,YN.44,YN.45,YN.46, YN.47,YN.48,YN.49,YN.50,YN.51, YN.52,YN.38,YN.39,YN.40,YN.41	13416.97
118	26-A	YN.58,YN.59,YN.60,YN.61,YN.62, YN.63,YN.40,YN.39,YN.53,YN.54, YN.55,YN.56,YN.57	12632.04

NoktaNo	Y	X	NoktaNo	Y	X
YN.1	634129.86	4084608.89	YN.2	634150.20	4084547.24
YN.3	634081.11	4084471.39	YN.4	634075.46	4084482.80
YN.5	634097.91	4084555.77	YN.31	634153.88	4084539.68
YN.32	634165.20	4084540.67	YN.33	634159.49	4084487.21
YN.34	634153.80	4084473.98	YN.35	634145.75	4084469.06
YN.36	634134.95	4084460.70	YN.37	634086.36	4084468.42
YN.38	634291.90	4084685.36	YN.39	634340.55	4084622.75
YN.40	634352.20	4084603.67	YN.41	634345.52	4084600.28
YN.42	634309.32	4084575.84	YN.43	634284.32	4084583.02
YN.44	634275.39	4084552.67	YN.45	634270.10	4084549.05
YN.46	634227.89	4084520.61	YN.47	634210.92	4084510.03
YN.48	634208.04	4084513.58	YN.49	634181.90	4084551.26
YN.50	634230.11	4084566.74	YN.51	634207.92	4084580.65
YN.52	634214.99	4084626.75	YN.53	634333.36	4084700.32
YN.54	634384.63	4084709.46	YN.55	634355.13	4084729.84
YN.56	634386.44	4084744.08	YN.57	634410.15	4084754.66
YN.58	634446.11	4084771.22	YN.59	634505.64	4084665.38
YN.60	634470.33	4084671.81	YN.61	634399.32	4084684.76
YN.62	634376.96	4084616.23	YN.63	634376.71	4084616.11

### RÖLEVE KROKİSİ

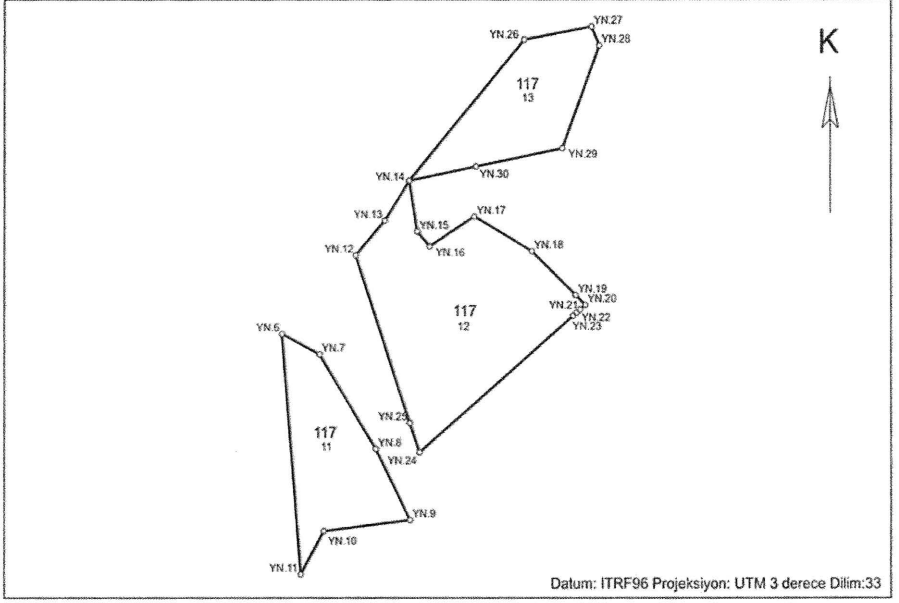

Datum: ITRF96 Projeksiyon: UTM 3 derece Dilim:33

Ada	Parsel	Noktalar	HesapAlan
117	11	YN.8,YN.9,YN.10,YN.11,YN.6, YN.7	8795.71
117	12	YN.24,YN.25,YN.12,YN.13,YN.14, YN.15,YN.16,YN.17,YN.18,YN.19, YN.20,YN.21,YN.22,YN.23	18167.63
117	13	YN.26,YN.27,YN.28,YN.29,YN.30, YN.14	8124.99

NoktaNo	Y	X	NoktaNo	Y	X
YN.6	633955.78	4084704.85	YN.7	633986.00	4084689.65
YN.8	634032.03	4084618.85	YN.9	634059.52	4084565.51
YN.10	633989.51	4084557.21	YN.11	633971.06	4084524.37
YN.12	634015.46	4084763.90	YN.13	634039.09	4084790.00
YN.14	634058.82	4084820.32	YN.15	634065.14	4084781.64
YN.16	634075.21	4084770.50	YN.17	634110.64	4084793.06
YN.18	634156.65	4084766.76	YN.19	634191.66	4084733.72
YN.20	634199.50	4084726.32	YN.21	634195.32	4084722.85
YN.22	634192.26	4084720.31	YN.23	634189.66	4084718.16
YN.24	634067.05	4084616.40	YN.25	634059.31	4084638.51
YN.26	634150.40	4084925.78	YN.27	634204.38	4084935.40
YN.28	634210.67	4084921.51	YN.29	634180.86	4084844.40
YN.30	634111.99	4084830.81			

## RÖLEVE KROKİSİ

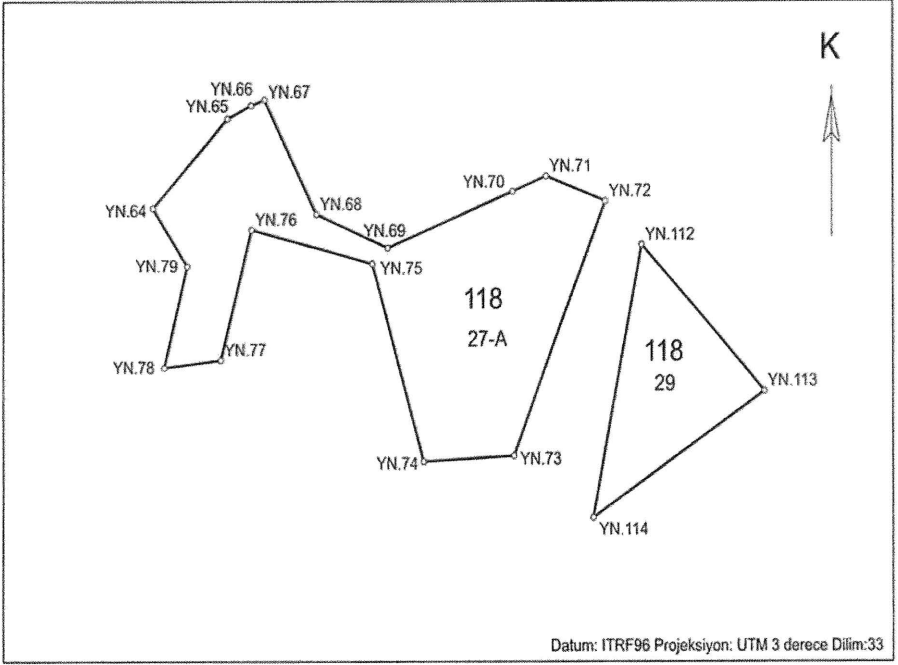

Ada	Parsel	Noktalar	HesapAlan
118	27-A	YN.72,YN.73,YN.74,YN.75,YN.76, YN.77,YN.78,YN.79,YN.64,YN.65, YN.66,YN.67,YN.68,YN.69,YN.70, YN.71	16945.45
118	29	YN.113,YN.114,YN.112	5285.79

NoktaNo	Y	X	NoktaNo	Y	X
YN.64	634365.67	4084581.62	YN.65	634406.66	4084623.73
YN.66	634419.78	4084629.98	YN.67	634427.21	4084632.64
YN.68	634455.91	4084578.69	YN.69	634495.45	4084562.77
YN.70	634564.71	4084589.30	YN.71	634583.52	4084596.50
YN.72	634616.15	4084584.75	YN.73	634565.58	4084464.46
YN.74	634515.27	4084461.81	YN.75	634486.87	4084555.30
YN.76	634420.03	4084571.44	YN.77	634402.95	4084509.65
YN.78	634371.80	4084506.02	YN.79	634384.55	4084554.23
YN.112	634636.14	4084564.12	YN.113	634703.97	4084494.84
YN.114	634609.49	4084435.50			

RÖLEVE KROKİSİ

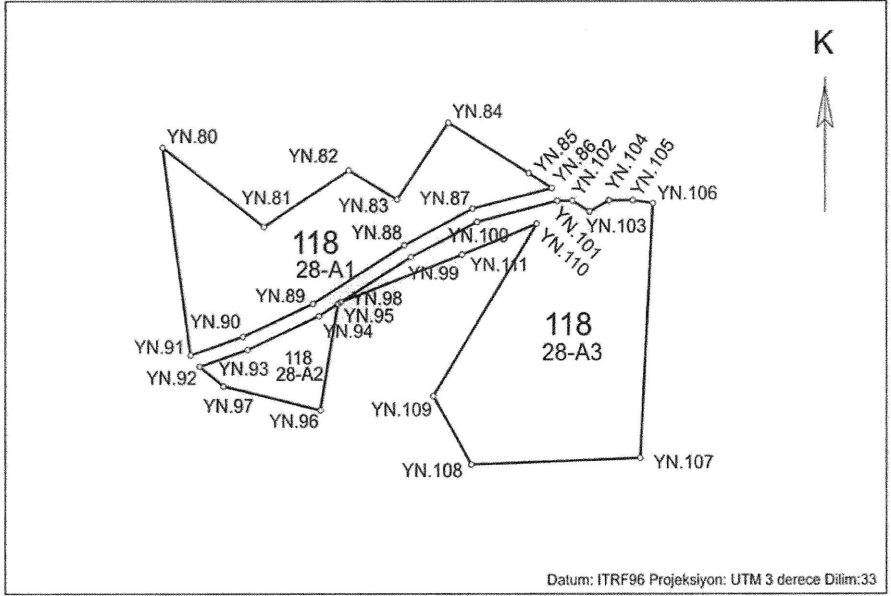

Ada	Parsel	Noktalar	HesapAlan
118	28-A1	YN.91,YN.80,YN.81,YN.82,YN.83, YN.84,YN.85,YN.86,YN.87,YN.88, YN.89,YN.90	6957.15
118	28-A2	YN.95,YN.96,YN.97,YN.92,YN.93, YN.94	1409.58
118	28-A3	YN.106,YN.107,YN.108,YN.109, YN.110,YN.111,YN.98,YN.99, YN.100,YN.101,YN.102,YN.103, YN.104,YN.105	9199.41

NoktaNo	Y	X	NoktaNo	Y	X
YN.80	634519.30	4084763.22	YN.81	634565.97	4084729.04
YN.82	634605.49	4084753.40	YN.83	634627.79	4084740.82
YN.84	634651.27	4084773.97	YN.85	634688.33	4084752.17
YN.86	634699.15	4084745.74	YN.87	634662.53	4084736.83
YN.88	634631.25	4084721.26	YN.89	634589.01	4084695.65
YN.90	634556.32	4084681.40	YN.91	634532.12	4084673.41
YN.92	634536.42	4084668.51	YN.93	634558.46	4084675.79
YN.94	634591.77	4084690.31	YN.95	634600.57	4084695.64
YN.96	634592.44	4084649.70	YN.97	634547.35	4084659.95
YN.98	634601.76	4084696.36	YN.99	634634.15	4084716.00
YN.100	634664.60	4084731.16	YN.101	634701.57	4084740.15
YN.102	634708.49	4084740.19	YN.103	634716.35	4084735.51
YN.104	634725.30	4084740.28	YN.105	634736.35	4084740.34
YN.106	634745.50	4084739.08	YN.107	634739.74	4084628.89
YN.108	634661.99	4084626.08	YN.109	634644.52	4084655.78
YN.110	634692.12	4084730.36	YN.111	634657.63	4084717.05

RÖLEVE KROKİSİ

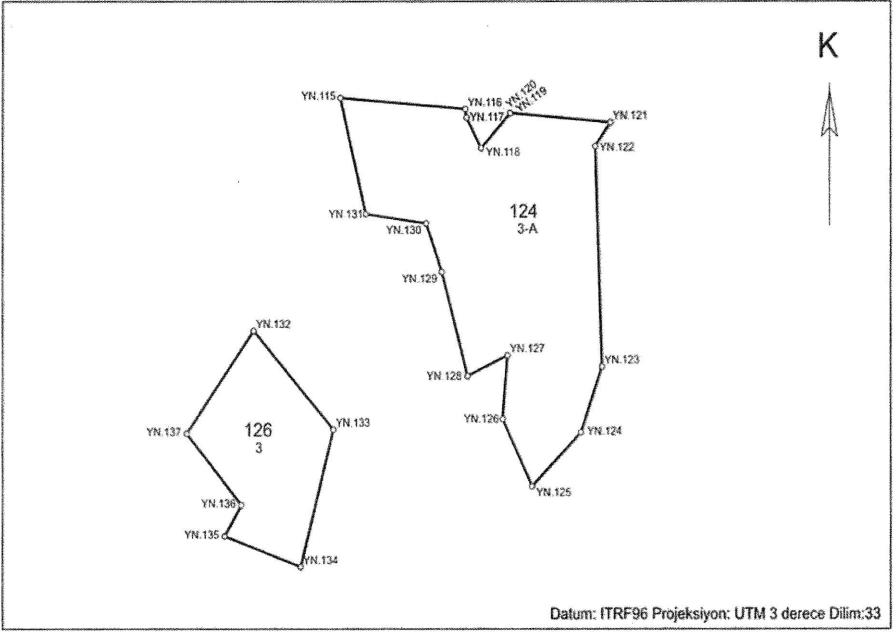

Datum: ITRF96 Projeksiyon: UTM 3 derece Dilim:33

Ada	Parsel	Noktalar	HesapAlan
124	3-A	YN.121,YN.122,YN.123,YN.124, YN.125,YN.126,YN.127,YN.128, YN.129,YN.130,YN.131,YN.115, YN.116,YN.117,YN.118,YN.119, YN.120	32018.06
126	3	YN.133,YN.134,YN.135,YN.136, YN.137,YN.132	11060.35

NoktaNo	Y	X	NoktaNo	Y	X
YN.115	634941.33	4084597.88	YN.116	635041.05	4084589.71
YN.117	635041.98	4084583.58	YN.118	635053.74	4084562.00
YN.119	635076.90	4084586.67	YN.120	635076.95	4084586.77
YN.121	635157.14	4084580.20	YN.122	635144.99	4084563.41
YN.123	635150.54	4084405.21	YN.124	635133.59	4084358.62
YN.125	635094.34	4084319.90	YN.126	635070.96	4084368.24
YN.127	635074.74	4084413.28	YN.128	635042.85	4084398.61
YN.129	635022.60	4084472.89	YN.130	635010.00	4084507.78
YN.131	634961.96	4084514.61	YN.132	634871.83	4084430.91
YN.133	634935.79	4084360.89	YN.134	634909.75	4084262.20
YN.135	634848.61	4084284.39	YN.136	634862.02	4084306.58
YN.137	634818.14	4084358.01			

RÖLEVE KROKİSİ

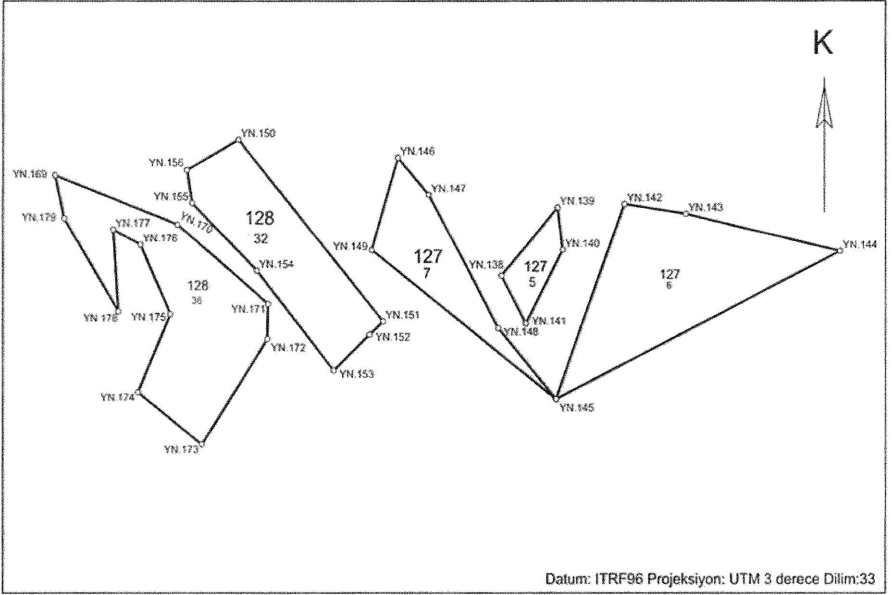

Datum: ITRF96 Projeksiyon: UTM 3 derece Dilim:33

Ada	Parsel	Noktalar	HesapAlan
127	5	YN.140,YN.141,YN.138,YN.139	1924.14
127	6	YN.142,YN.143,YN.144,YN.145	14006.84
127	7	YN.147,YN.148,YN.145,YN.149, YN.146	6043.26
128	32	YN.154,YN.155,YN.156,YN.150, YN.151,YN.152,YN.153	10210.39
128	36	YN.170,YN.171,YN.172,YN.173, YN.174,YN.175,YN.176,YN.177, YN.178,YN.179,YN.169	13635.28

NoktaNo	Y	X	NoktaNo	Y	X
YN.138	634643.46	4083989.32	YN.139	634688.73	4084041.14
YN.140	634692.91	4084008.90	YN.141	634662.93	4083953.11
YN.142	634742.59	4084043.68	YN.143	634791.63	4084036.17
YN.144	634915.62	4084007.72	YN.145	634687.47	4083895.91
YN.146	634559.80	4084079.17	YN.147	634584.85	4084050.84
YN.148	634640.97	4083949.63	YN.149	634538.86	4084008.92
YN.150	634431.44	4084092.82	YN.151	634548.07	4083954.81
YN.152	634537.30	4083944.76	YN.153	634508.34	4083917.75
YN.154	634446.36	4083993.24	YN.155	634394.20	4084044.71
YN.156	634390.03	4084070.05	YN.169	634283.48	4084065.85
YN.170	634382.64	4084028.39	YN.171	634455.38	4083968.04
YN.172	634454.99	4083941.62	YN.173	634402.07	4083861.78
YN.174	634350.93	4083901.25	YN.175	634376.75	4083960.36
YN.176	634352.85	4084013.16	YN.177	634330.89	4084024.64
YN.178	634335.05	4083962.51	YN.179	634291.08	4084032.93

### RÖLEVE KROKİSİ

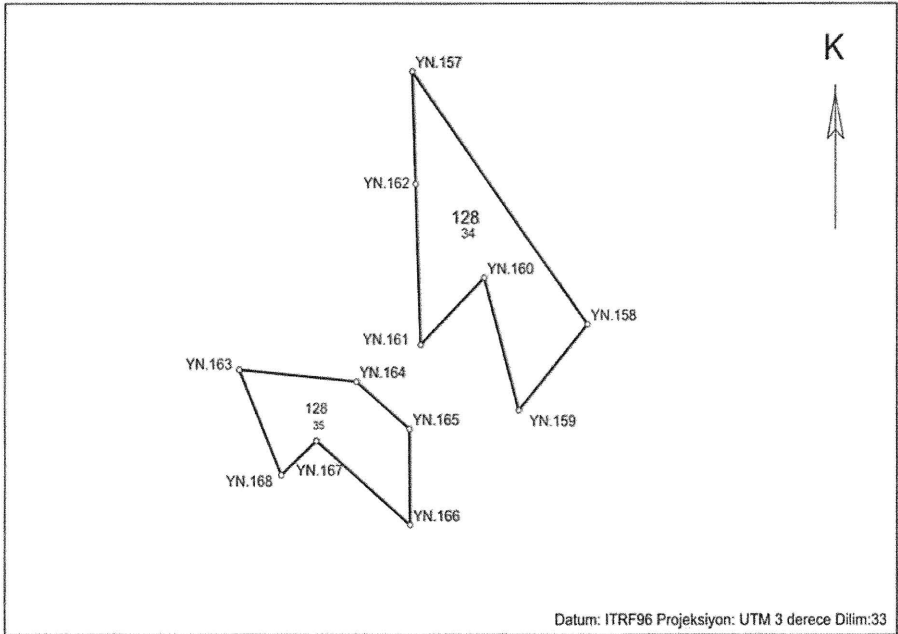

Datum: ITRF96 Projeksiyon: UTM 3 derece Dilim:33

Ada	Parsel	Noktalar	HesapAlan
128	34	YN.157,YN.158,YN.159,YN.160, YN.161,YN.162	7713.59
128	35	YN.166,YN.167,YN.168,YN.163, YN.164,YN.165	4250.25

NoktaNo	Y	X	NoktaNo	Y	X
YN.157	634438.71	4084422.85	YN.158	634543.88	4084286.95
YN.159	634502.81	4084241.01	YN.160	634481.88	4084312.23
YN.161	634443.83	4084276.01	YN.162	634440.80	4084362.87
YN.163	634334.89	4084262.80	YN.164	634405.08	4084256.42
YN.165	634437.11	4084231.14	YN.166	634437.54	4084179.85
YN.167	634381.02	4084224.90	YN.168	634360.03	4084206.67

RÖLEVE KROKİSİ

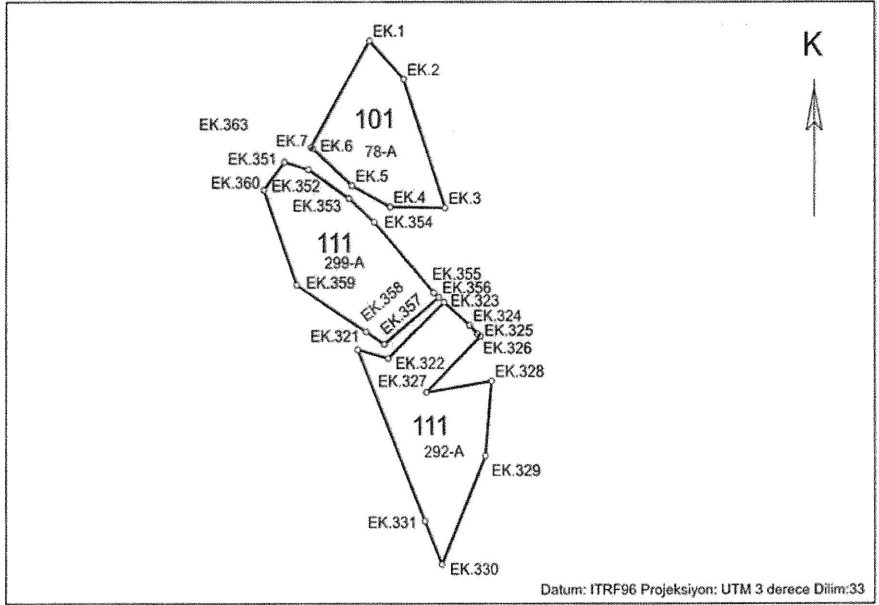

Datum: ITRF96 Projeksiyon: UTM 3 derece Dilim:33

Ada	Parsel	Noktalar	HesapAlan
101	78-A	EK.7,EK.1,EK.2,EK.3,EK.4,EK.5, EK.6	3486.86
111	292-A	EK.331,EK.321,EK.322,EK.323, EK.324,EK.325,EK.326,EK.327, EK.328,EK.329,EK.330	4815.03
111	299-A	EK.351,EK.352,EK.353,EK.354, EK.355,EK.356,EK.357,EK.358, EK.359,EK.360	4455.88

NoktaNo	Y	X	NoktaNo	Y	X
EK.1	635509.99	4084225.26	EK.2	635529.14	4084205.38
EK.3	635552.37	4084139.70	EK.4	635521.53	4084140.24
EK.5	635500.36	4084151.03	EK.6	635478.49	4084169.85
EK.7	635477.36	4084170.50	EK.321	635503.57	4084067.60
EK.322	635520.52	4084063.07	EK.323	635551.88	4084092.06
EK.324	635566.03	4084080.18	EK.325	635570.49	4084075.49
EK.326	635572.12	4084074.38	EK.327	635541.88	4084045.78
EK.328	635578.48	4084051.66	EK.329	635575.02	4084013.50
EK.330	635550.75	4083958.47	EK.331	635541.13	4083980.36
EK.351	635462.40	4084163.02	EK.352	635475.97	4084159.22
EK.353	635498.69	4084144.55	EK.354	635512.63	4084132.54
EK.355	635546.20	4084096.82	EK.356	635548.91	4084094.54
EK.357	635518.39	4084070.40	EK.358	635508.19	4084076.73
EK.359	635469.46	4084100.81	EK.360	635450.67	4084148.86

## RÖLEVE KROKİSİ

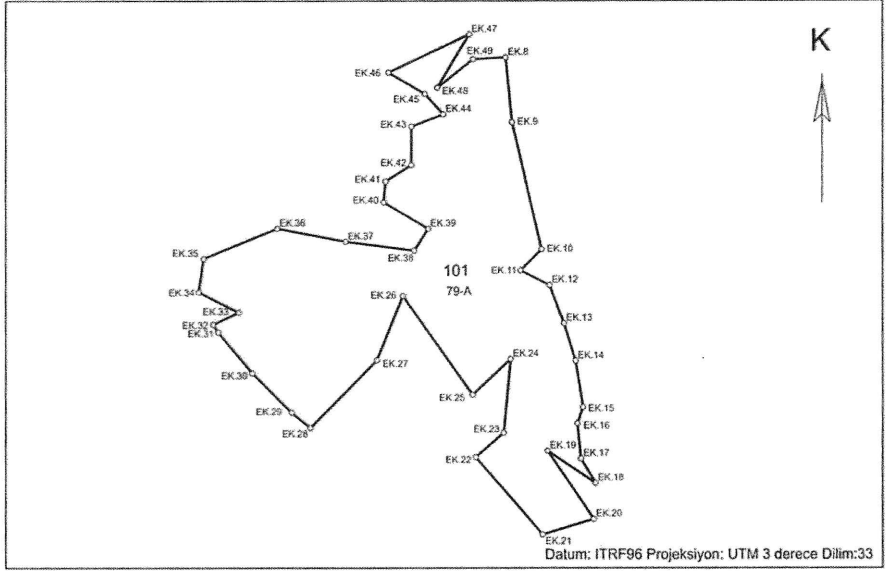

Ada	Parsel	Noktalar	HesapAlan
101	79-A	EK.32,EK.33,EK.34,EK.35,EK.36, EK.37,EK.38,EK.39,EK.40,EK.41, EK.42,EK.43,EK.44,EK.45,EK.46, EK.47,EK.48,EK.49,EK.8,EK.9, EK.10,EK.11,EK.12,EK.13,EK.14, EK.15,EK.16,EK.17,EK.18,EK.19, EK.20,EK.21,EK.22,EK.23,EK.24, EK.25,EK.26,EK.27,EK.28,EK.29, EK.30,EK.31	57405.06

NoktaNo	Y	X	NoktaNo	Y	X
EK.8	635599.60	4084518.89	EK.9	635605.05	4084463.31
EK.10	635631.06	4084354.23	EK.11	635612.49	4084336.15
EK.12	635637.83	4084323.67	EK.13	635650.40	4084291.34
EK.14	635660.50	4084259.23	EK.15	635666.90	4084219.65
EK.16	635662.04	4084205.65	EK.17	635665.21	4084175.58
EK.18	635677.87	4084154.38	EK.19	635636.16	4084182.31
EK.20	635676.30	4084123.63	EK.21	635632.04	4084110.37
EK.22	635573.37	4084176.84	EK.23	635597.93	4084197.76
EK.24	635603.95	4084260.85	EK.25	635570.65	4084230.39
EK.26	635508.89	4084314.68	EK.27	635485.88	4084259.95
EK.28	635427.41	4084201.97	EK.29	635410.90	4084215.20
EK.30	635376.31	4084248.95	EK.31	635346.40	4084283.94
EK.32	635341.98	4084290.48	EK.33	635364.52	4084300.72
EK.34	635329.20	4084318.01	EK.35	635333.51	4084346.59
EK.36	635398.22	4084372.43	EK.37	635458.23	4084361.06
EK.38	635518.85	4084353.32	EK.39	635531.22	4084372.19
EK.40	635491.93	4084394.67	EK.41	635493.51	4084412.41
EK.42	635516.32	4084426.54	EK.43	635516.31	4084459.64
EK.44	635544.63	4084470.27	EK.45	635528.28	4084487.70
EK.46	635496.01	4084506.02	EK.47	635567.58	4084538.76
EK.48	635539.18	4084493.01	EK.49	635571.04	4084517.34

## RÖLEVE KROKİSİ

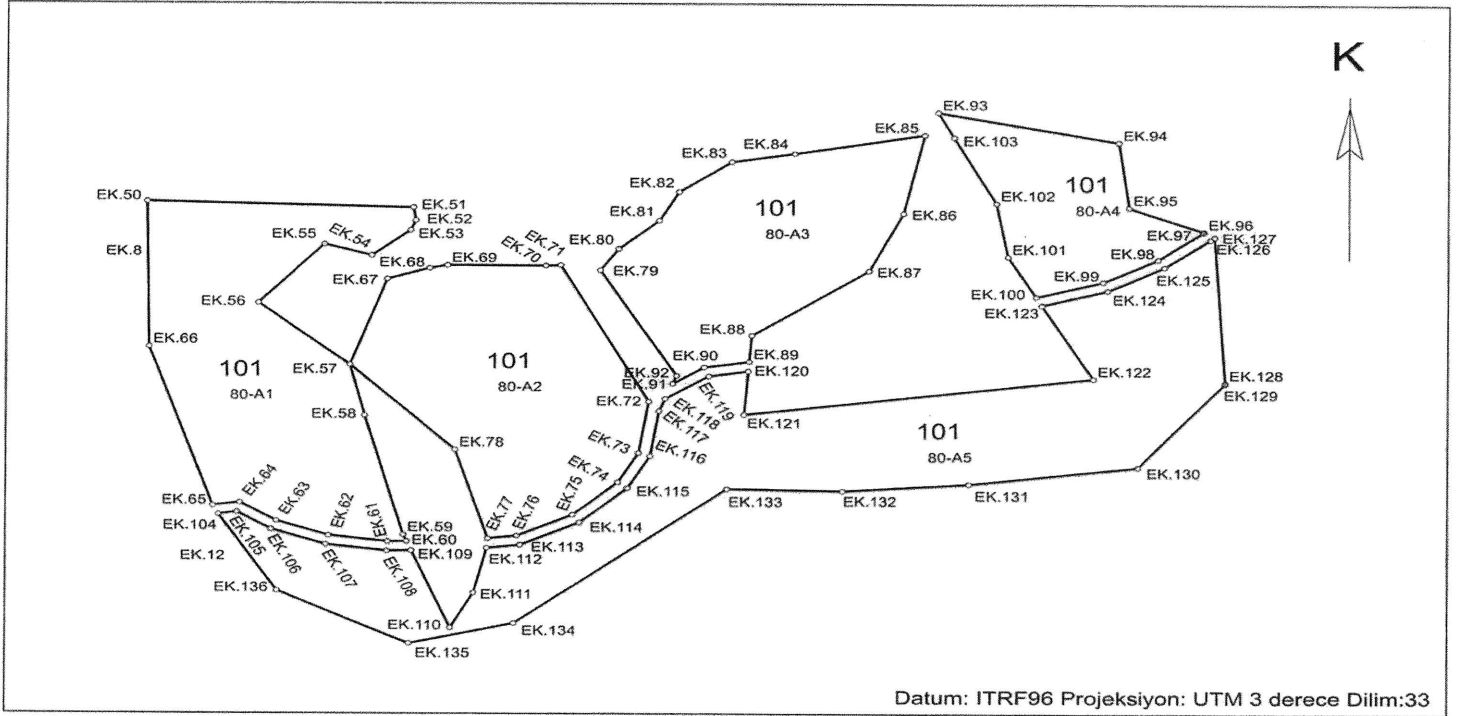

## KOORDİNELİ ÖZET ALAN ÇİZELGESİ

Ada	Parsel	Noktalar	HesapAlan
101	80-A1	EK.50,EK.51,EK.52,EK.53,EK.54, EK.55,EK.56,EK.57,EK.58,EK.59, EK.60,EK.61,EK.62,EK.63,EK.64, EK.65,EK.66	18976.14
101	80-A2	EK.77,EK.78,EK.57,EK.67,EK.68, EK.69,EK.70,EK.71,EK.72,EK.73, EK.74,EK.75,EK.76	16929.91
101	80-A3	EK.91,EK.92,EK.79,EK.80,EK.81, EK.82,EK.83,EK.84,EK.85,EK.86, EK.87,EK.88,EK.89,EK.90	14045.73
101	80-A4	EK.100,EK.101,EK.102,EK.103, EK.93,EK.94,EK.95,EK.96,EK.97, EK.98,EK.99	7733.44
101	80-A5	EK.109,EK.110,EK.111,EK.112, EK.113,EK.114,EK.115,EK.116, EK.117,EK.118,EK.119,EK.120, EK.121,EK.122,EK.123,EK.124, EK.125,EK.126,EK.127,EK.128, EK.129,EK.130,EK.131,EK.132, EK.133,EK.134,EK.135,EK.136, EK.104,EK.105,EK.106,EK.107, EK.108	29901.05

Datum: ITRF96 Projeksiyon: UTM 3 derece Dilim:33

NoktaNo	Y	X	NoktaNo	Y	X
EK.50	635622.19	4084555.98	EK.51	635755.95	4084552.48
EK.52	635757.09	4084544.19	EK.53	635754.73	4084537.92
EK.54	635735.44	4084521.53	EK.55	635711.92	4084528.71
EK.56	635678.55	4084490.92	EK.57	635724.82	4084451.00
EK.58	635732.32	4084418.39	EK.59	635751.77	4084342.25
EK.60	635753.44	4084337.99	EK.61	635744.05	4084337.83
EK.62	635714.70	4084341.68	EK.63	635688.17	4084351.05
EK.64	635669.67	4084362.94	EK.65	635656.14	4084360.92
EK.66	635623.53	4084462.36	EK.67	635743.21	4084506.33
EK.68	635764.23	4084513.33	EK.69	635773.07	4084515.26
EK.70	635822.32	4084515.08	EK.71	635829.84	4084515.41
EK.72	635874.24	4084427.59	EK.73	635869.24	4084394.71
EK.74	635858.96	4084376.17	EK.75	635836.35	4084355.29
EK.76	635808.39	4084341.62	EK.77	635793.94	4084339.92
EK.78	635777.22	4084396.57	EK.79	635849.69	4084512.27
EK.80	635858.94	4084526.14	EK.81	635879.18	4084544.42
EK.82	635889.02	4084562.73	EK.83	635915.03	4084582.02
EK.84	635946.55	4084587.56	EK.85	636012.46	4084599.60
EK.86	636001.86	4084549.28	EK.87	635984.18	4084512.10
EK.88	635925.42	4084470.47	EK.89	635924.19	4084453.38
EK.90	635901.76	4084449.66	EK.91	635886.13	4084439.11
EK.92	635888.09	4084444.24	EK.93	636019.14	4084614.19
EK.94	636109.72	4084595.08	EK.95	636115.02	4084553.25
EK.96	636153.36	4084537.94	EK.97	636152.85	4084537.54
EK.98	636130.01	4084519.94	EK.99	636102.10	4084505.29
EK.100	636068.58	4084495.51	EK.101	636054.38	4084521.50
EK.102	636048.53	4084555.78	EK.103	636027.23	4084598.11
EK.104	635659.03	4084355.28	EK.105	635668.32	4084356.67
EK.106	635685.51	4084345.62	EK.107	635713.29	4084335.81
EK.108	635743.70	4084331.82	EK.109	635755.77	4084332.02
EK.110	635775.27	4084282.10	EK.111	635786.78	4084304.83
EK.112	635793.47	4084333.82	EK.113	635810.10	4084335.77
EK.114	635839.78	4084350.29	EK.115	635863.74	4084372.42
EK.116	635875.01	4084392.75	EK.117	635879.38	4084421.44
EK.118	635882.40	4084429.35	EK.119	635904.03	4084443.96
EK.120	635923.75	4084447.23	EK.121	635921.73	4084419.29
EK.122	636097.37	4084442.78	EK.123	636071.52	4084490.11
EK.124	636104.36	4084499.69	EK.125	636133.27	4084514.87
EK.126	636156.55	4084532.81	EK.127	636158.70	4084534.51
EK.128	636164.08	4084440.52	EK.129	636164.11	4084439.92
EK.130	636119.97	4084386.19	EK.131	636035.27	4084375.25
EK.132	635971.17	4084370.81	EK.133	635913.27	4084372.06
EK.134	635807.03	4084285.11	EK.135	635754.68	4084271.78
EK.136	635688.46	4084306.16			

RÖLEVE KROKİSİ

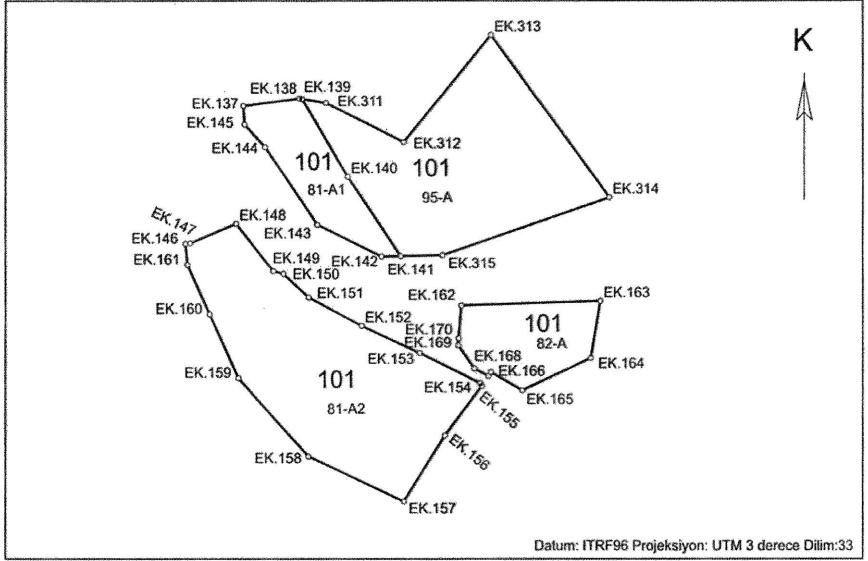

Datum: ITRF96 Projeksiyon: UTM 3 derece Dilim:33

Ada	Parsel	Noktalar	HesapAlan
101	82-A	EK.164,EK.165,EK.166,EK.167, EK.168,EK.169,EK.170,EK.162, EK.163	3144.79
101	95-A	EK.312,EK.313,EK.314,EK.315, EK.141,EK.140,EK.139,EK.311	10868.78
101	81-A1	EK.141,EK.142,EK.143,EK.144, EK.145,EK.137,EK.138,EK.139, EK.140	3078.86
101	81-A2	EK.159,EK.160,EK.161,EK.146, EK.147,EK.148,EK.149,EK.150, EK.151,EK.152,EK.153,EK.154, EK.155,EK.156,EK.157,EK.158	11987.60

NoktaNo	Y	X	NoktaNo	Y	X
EK.137	636087.83	4084814.82	EK.138	636120.67	4084819.07
EK.139	636122.33	4084818.80	EK.140	636148.95	4084774.48
EK.141	636180.37	4084729.62	EK.142	636168.97	4084729.39
EK.143	636131.28	4084747.30	EK.144	636100.71	4084791.33
EK.145	636088.50	4084804.15	EK.146	636054.03	4084736.60
EK.147	636056.77	4084736.88	EK.148	636083.65	4084747.93
EK.149	636105.64	4084721.00	EK.150	636111.46	4084719.48
EK.151	636126.21	4084706.07	EK.152	636157.24	4084690.07
EK.153	636191.50	4084674.58	EK.154	636226.54	4084657.41
EK.155	636227.35	4084655.90	EK.156	636206.01	4084627.74
EK.157	636182.25	4084590.28	EK.158	636126.10	4084615.84
EK.159	636085.11	4084660.33	EK.160	636068.19	4084696.67
EK.161	636055.16	4084724.67	EK.162	636215.50	4084701.50
EK.163	636296.70	4084704.00	EK.164	636291.10	4084671.65
EK.165	636250.95	4084653.39	EK.166	636232.61	4084663.77
EK.167	636231.16	4084661.51	EK.168	636223.11	4084665.78
EK.169	636213.72	4084678.95	EK.170	636214.03	4084682.93
EK.311	636136.18	4084816.58	EK.312	636182.09	4084794.10
EK.313	636232.46	4084855.22	EK.314	636301.97	4084762.74
EK.315	636204.61	4084730.11			

RÖLEVE KROKİSİ

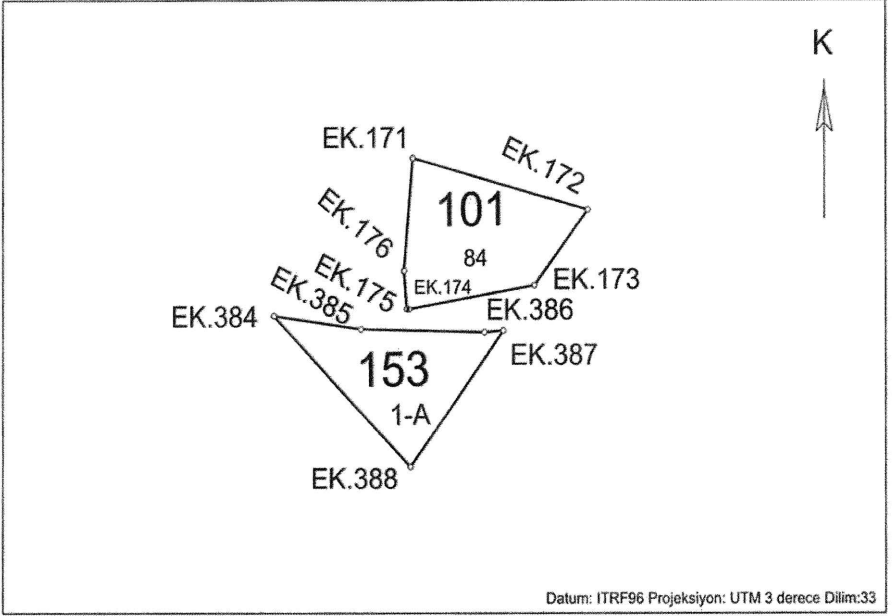

Datum: ITRF96 Projeksiyon: UTM 3 derece Dilim:33

Ada	Parsel	Noktalar	HesapAlan
101	84	EK.176,EK.171,EK.172,EK.173, EK.174,EK.175	1623.43
153	1-A	EK.387,EK.388,EK.384,EK.385, EK.386	1379.13

NoktaNo	Y	X	NoktaNo	Y	X
EK.171	634809.34	4084781.51	EK.172	634864.41	4084766.65
EK.173	634847.89	4084744.94	EK.174	634808.25	4084738.17
EK.175	634807.45	4084738.19	EK.176	634806.52	4084749.07
EK.384	634765.59	4084736.30	EK.385	634793.03	4084732.51
EK.386	634832.09	4084731.63	EK.387	634838.16	4084732.14
EK.388	634808.58	4084693.26			

### RÖLEVE KROKİSİ

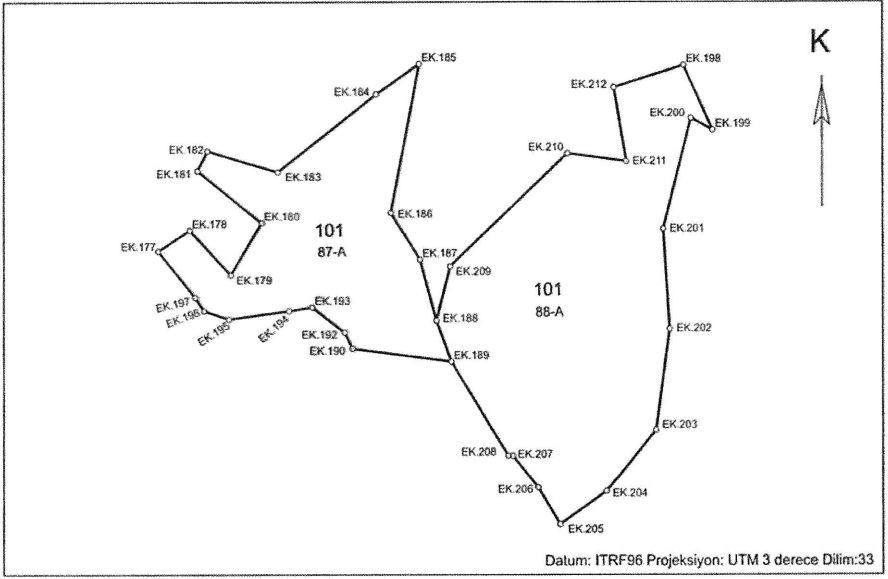

Ada	Parsel	Noktalar	HesapAlan
101	87-A	EK.190,EK.191,EK.192,EK.193, EK.194,EK.195,EK.196,EK.197, EK.177,EK.178,EK.179,EK.180, EK.181,EK.182,EK.183,EK.184, EK.185,EK.186,EK.187,EK.188, EK.189	23397.58
101	88-A	EK.188,EK.209,EK.210,EK.211, EK.212,EK.198,EK.199,EK.200, EK.201,EK.202,EK.203,EK.204, EK.205,EK.206,EK.207,EK.208, EK.189	39062.78

NoktaNo	Y	X	NoktaNo	Y	X
EK.177	634850.49	4084794.60	EK.178	634875.46	4084810.70
EK.179	634907.88	4084776.38	EK.180	634932.06	4084816.31
EK.181	634881.66	4084855.97	EK.182	634889.40	4084870.94
EK.183	634944.42	4084854.91	EK.184	635020.46	4084913.64
EK.185	635054.29	4084936.15	EK.186	635031.97	4084823.72
EK.187	635054.86	4084787.97	EK.188	635067.65	4084741.96
EK.189	635079.59	4084711.09	EK.190	635002.20	4084720.87
EK.191	635002.04	4084720.89	EK.192	634996.04	4084732.96
EK.193	634970.90	4084751.94	EK.194	634953.06	4084749.23
EK.195	634906.40	4084743.06	EK.196	634886.83	4084749.30
EK.197	634879.80	4084759.56	EK.198	635260.67	4084934.95
EK.199	635283.45	4084886.44	EK.200	635266.42	4084895.48
EK.201	635244.53	4084811.20	EK.202	635249.59	4084735.33
EK.203	635238.88	4084659.30	EK.204	635200.14	4084612.69
EK.205	635164.21	4084587.79	EK.206	635147.25	4084615.36
EK.207	635127.58	4084639.79	EK.208	635123.86	4084639.83
EK.209	635078.59	4084782.93	EK.210	635170.04	4084868.82
EK.211	635215.47	4084862.68	EK.212	635205.93	4084918.63

### RÖLEVE KROKİSİ

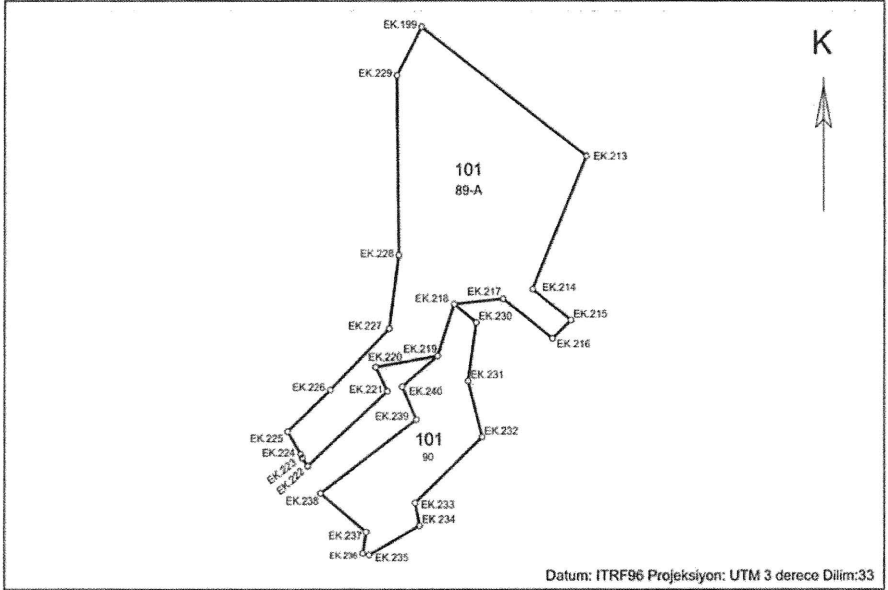

Ada	Parsel	Noktalar	HesapAlan
101	89-A	EK.213,EK.214,EK.215,EK.216, EK.217,EK.218,EK.219,EK.220, EK.221,EK.222,EK.223,EK.224, EK.225,EK.226,EK.227,EK.228, EK.229,EK.199	29231.93
101	90	EK.236,EK.237,EK.238,EK.239, EK.240,EK.219,EK.218,EK.230, EK.231,EK.232,EK.233,EK.234, EK.235	9597.52

NoktaNo	Y	X	NoktaNo	Y	X
EK.199	635283.45	4084886.44	EK.213	635418.68	4084786.36
EK.214	635374.86	4084682.85	EK.215	635406.35	4084658.52
EK.216	635391.34	4084644.40	EK.217	635350.63	4084675.30
EK.218	635310.52	4084671.19	EK.219	635296.91	4084631.03
EK.220	635246.24	4084622.62	EK.221	635255.87	4084604.05
EK.222	635190.37	4084545.77	EK.223	635185.87	4084552.00
EK.224	635184.41	4084554.95	EK.225	635173.49	4084572.70
EK.226	635209.20	4084604.93	EK.227	635257.38	4084652.19
EK.228	635265.01	4084709.23	EK.229	635263.38	4084848.98
EK.230	635328.60	4084656.81	EK.231	635321.99	4084611.80
EK.232	635333.53	4084568.28	EK.233	635278.46	4084517.07
EK.234	635282.20	4084499.54	EK.235	635240.95	4084476.73
EK.236	635235.82	4084478.00	EK.237	635238.69	4084494.54
EK.238	635201.05	4084524.51	EK.239	635279.54	4084581.92
EK.240	635267.83	4084607.52			

### RÖLEVE KROKİSİ

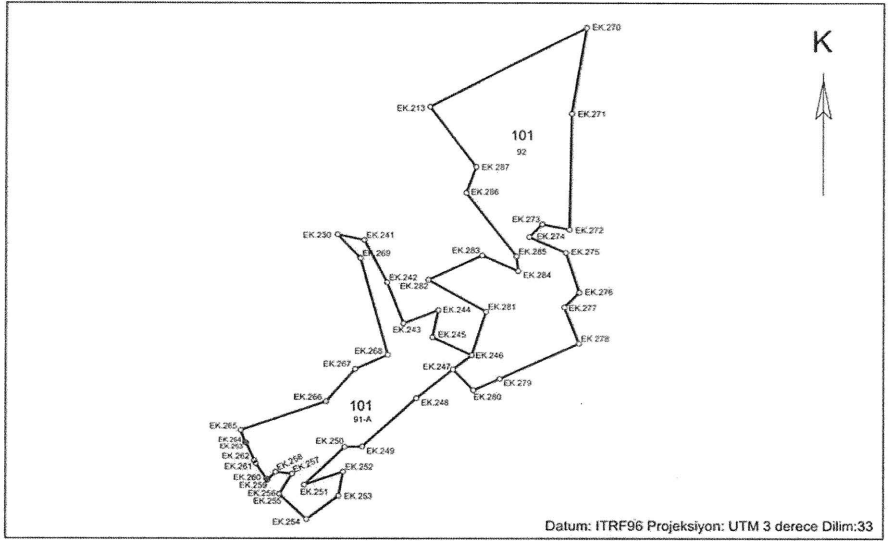

Datum: ITRF96 Projeksiyon: UTM 3 derece Dilim:33

Ada	Parsel	Noktalar	HesapAlan
101	91-A	EK.254,EK.255,EK.256,EK.257, EK.258,EK.259,EK.260,EK.261, EK.262,EK.263,EK.264,EK.265, EK.266,EK.267,EK.268,EK.269, EK.230,EK.241,EK.242,EK.243, EK.244,EK.245,EK.246,EK.247, EK.248,EK.249,EK.250,EK.251, EK.252,EK.253	17124.44
101	92	EK.213,EK.270,EK.271,EK.272, EK.273,EK.274,EK.275,EK.276, EK.277,EK.278,EK.279,EK.280, EK.247,EK.246,EK.281,EK.282, EK.283,EK.284,EK.285,EK.286, EK.287	31198.38

NoktaNo	Y	X	NoktaNo	Y	X
EK.213	635418.68	4084786.36	EK.230	635328.60	4084656.81
EK.241	635354.78	4084651.09	EK.242	635377.16	4084607.93
EK.243	635393.35	4084566.47	EK.244	635427.34	4084579.78
EK.245	635421.56	4084552.48	EK.246	635460.35	4084534.56
EK.247	635441.90	4084520.14	EK.248	635405.85	4084491.01
EK.249	635353.17	4084442.04	EK.250	635336.20	4084441.68
EK.251	635296.82	4084402.90	EK.252	635334.72	4084416.40
EK.253	635330.10	4084391.71	EK.254	635299.08	4084368.11
EK.255	635272.56	4084393.30	EK.256	635272.45	4084393.44
EK.257	635285.21	4084414.10	EK.258	635268.93	4084416.09
EK.259	635260.94	4084407.75	EK.260	635260.05	4084408.86
EK.261	635249.50	4084424.86	EK.262	635247.98	4084427.77
EK.263	635240.07	4084445.79	EK.264	635238.88	4084446.39
EK.265	635234.58	4084458.72	EK.266	635317.88	4084487.91
EK.267	635346.25	4084520.48	EK.268	635378.07	4084535.02
EK.269	635351.02	4084632.46	EK.270	635571.48	4084865.80
EK.271	635557.40	4084779.41	EK.272	635555.51	4084661.59
EK.273	635529.28	4084667.07	EK.274	635516.48	4084654.11
EK.275	635552.11	4084637.78	EK.276	635564.94	4084597.66
EK.277	635550.67	4084582.66	EK.278	635564.70	4084546.23
EK.279	635487.92	4084510.61	EK.280	635461.88	4084498.97
EK.281	635474.27	4084578.20	EK.282	635417.35	4084610.41
EK.283	635470.32	4084635.10	EK.284	635505.75	4084619.12
EK.285	635504.03	4084634.27	EK.286	635454.40	4084699.11
EK.287	635464.18	4084725.47			

### RÖLEVE KROKİSİ

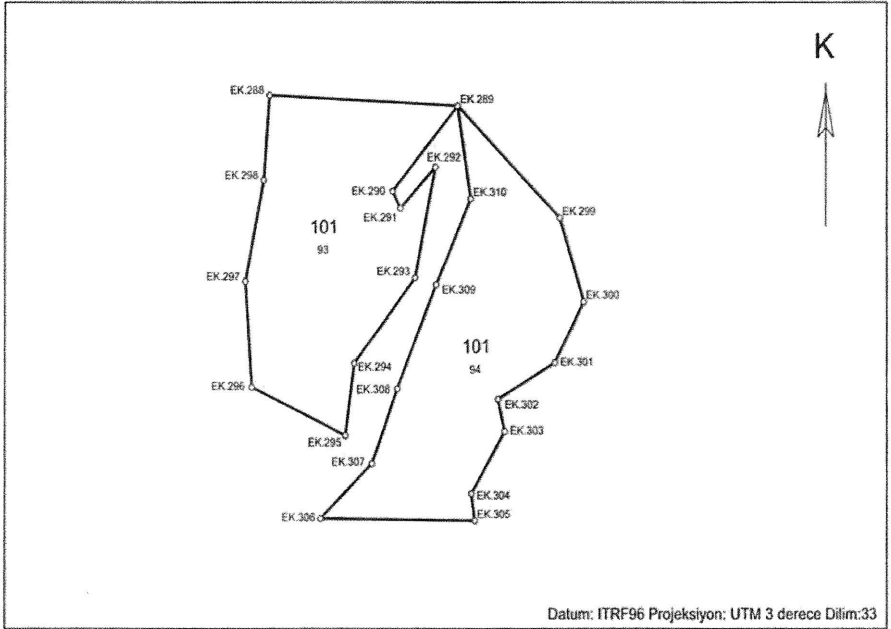

Ada	Parsel	Noktalar	HesapAlan
101	93	EK.289,EK.290,EK.291,EK.292, EK.293,EK.294,EK.295,EK.296, EK.297,EK.298,EK.288	27302.42
101	94	EK.306,EK.307,EK.308,EK.309, EK.310,EK.289,EK.299,EK.300, EK.301,EK.302,EK.303,EK.304, EK.305	26325.32

NoktaNo	Y	X	NoktaNo	Y	X
EK.288	635586.89	4084870.43	EK.289	635740.74	4084862.67
EK.290	635687.44	4084800.76	EK.291	635693.93	4084788.21
EK.292	635722.59	4084818.41	EK.293	635706.15	4084737.01
EK.294	635656.31	4084674.77	EK.295	635649.00	4084622.39
EK.296	635572.68	4084657.40	EK.297	635567.41	4084734.37
EK.298	635582.24	4084808.86	EK.299	635824.63	4084781.22
EK.300	635844.23	4084719.48	EK.301	635820.53	4084675.03
EK.302	635773.91	4084648.67	EK.303	635779.55	4084625.27
EK.304	635752.17	4084580.22	EK.305	635754.87	4084560.40
EK.306	635628.64	4084562.11	EK.307	635670.64	4084602.01
EK.308	635691.45	4084656.18	EK.309	635723.21	4084731.87
EK.310	635751.45	4084795.22			

### RÖLEVE KROKİSİ

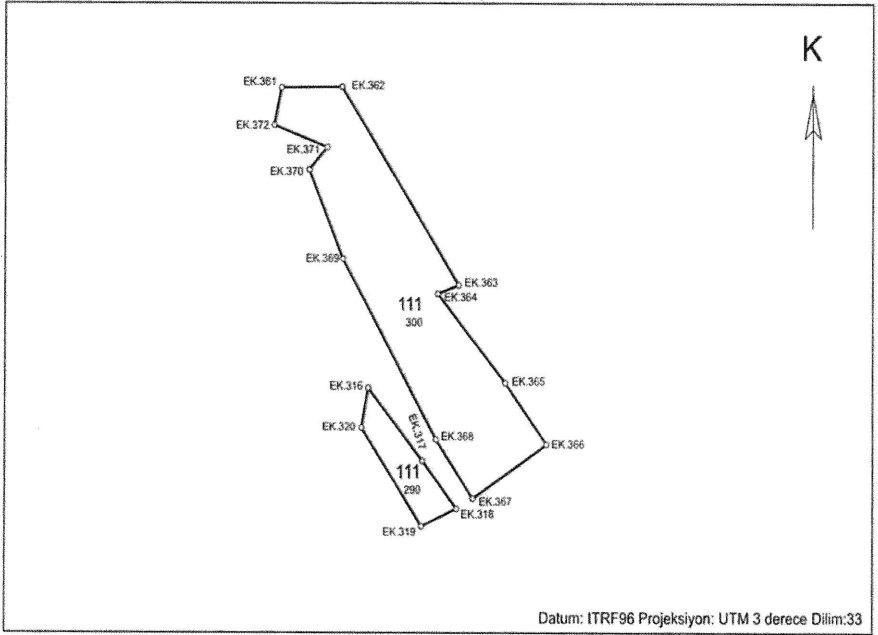

Ada	Parsel	Noktalar	Hesap Alan
111	290	EK.319,EK.320,EK.316,EK.317, EK.318	2722.05
111	300	EK.367,EK.368,EK.369,EK.370, EK.371,EK.372,EK.361,EK.362, EK.363,EK.364,EK.365,EK.366	20895.19

NoktaNo	Y	X	NoktaNo	Y	X
EK.316	635333.89	4084105.91	EK.317	635379.26	4084052.81
EK.318	635408.05	4084017.96	EK.319	635378.51	4084005.26
EK.320	635328.37	4084076.86	EK.361	635261.33	4084323.79
EK.362	635311.44	4084324.22	EK.363	635409.45	4084180.36
EK.364	635391.83	4084174.05	EK.365	635448.33	4084109.35
EK.366	635482.82	4084064.69	EK.367	635421.47	4084025.49
EK.368	635390.69	4084068.29	EK.369	635312.64	4084199.34
EK.370	635284.30	4084264.07	EK.371	635299.22	4084280.28
EK.372	635255.27	4084296.36			

RÖLEVE KROKİSİ

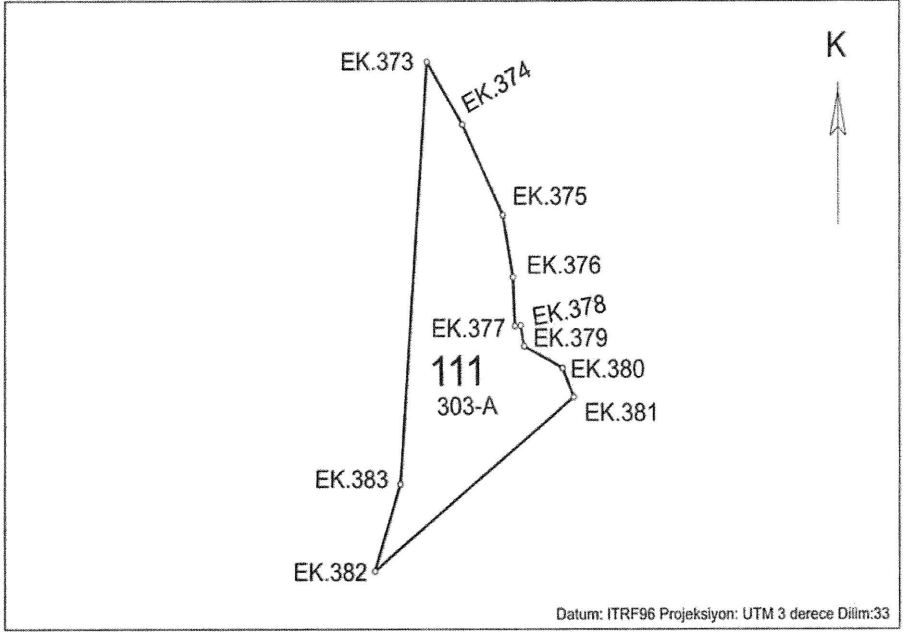

Ada	Parsel	Noktalar	HesapAlan
111	303-A	EK.376,EK.377,EK.378,EK.379, EK.380,EK.381,EK.382,EK.383, EK.373,EK.374,EK.375	5012.68

NoktaNo	Y	X	NoktaNo	Y	X
EK.373	635179.40	4084545.83	EK.374	635192.45	4084525.16
EK.375	635207.36	4084495.02	EK.376	635211.01	4084474.40
EK.377	635211.73	4084458.36	EK.378	635213.83	4084458.51
EK.379	635215.03	4084451.76	EK.380	635229.19	4084444.58
EK.381	635233.27	4084435.08	EK.382	635160.15	4084377.16
EK.383	635169.67	4084406.21			

RÖLEVE KROKİSİ

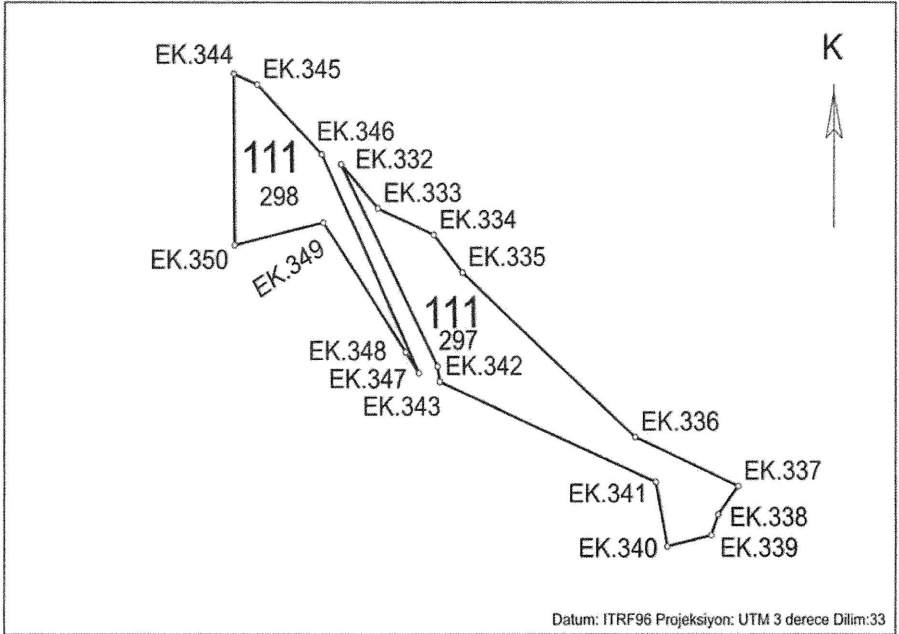

Ada	Parsel	Noktalar	HesapAlan
111	297	EK.340,EK.341,EK.342,EK.343, EK.332,EK.333,EK.334,EK.335, EK.336,EK.337,EK.338,EK.339	3012.75
111	298	EK.347,EK.348,EK.349,EK.350, EK.344,EK.345,EK.346	1555.45

NoktaNo	Y	X	NoktaNo	Y	X
EK.332	635665.42	4083987.51	EK.333	635678.39	4083973.81
EK.334	635697.87	4083965.31	EK.335	635708.00	4083953.59
EK.336	635768.40	4083902.60	EK.337	635804.33	4083887.23
EK.338	635797.34	4083878.31	EK.339	635794.87	4083871.87
EK.340	635779.55	4083868.46	EK.341	635775.54	4083888.52
EK.342	635700.00	4083919.83	EK.343	635699.30	4083924.56
EK.344	635627.80	4084015.75	EK.345	635635.98	4084012.38
EK.346	635658.67	4083990.66	EK.347	635692.87	4083922.45
EK.348	635688.20	4083928.94	EK.349	635659.24	4083969.19
EK.350	635628.22	4083962.13			

RÖLEVE KROKİSİ

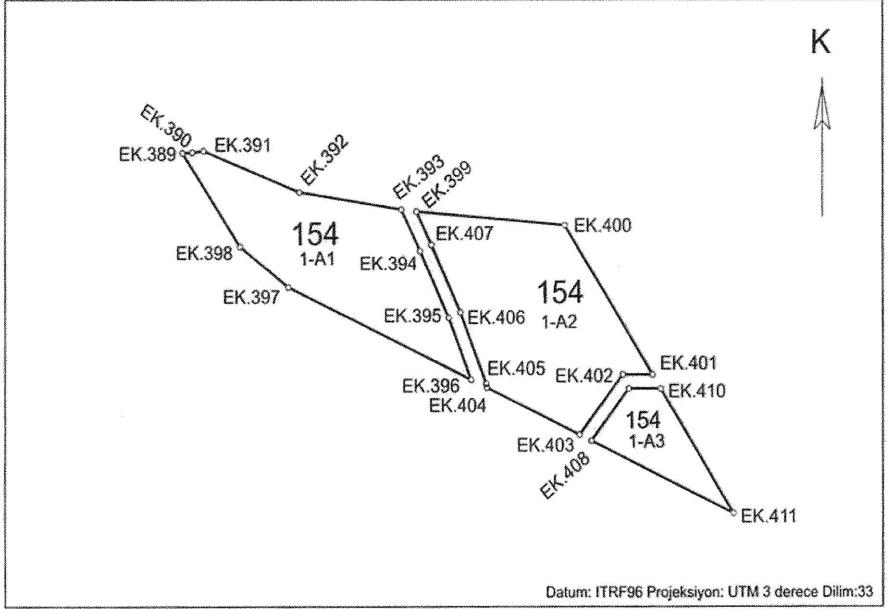

Ada	Parsel	Noktalar	HesapAlan
154	1-A1	EK.391,EK.392,EK.393,EK.394, EK.395,EK.396,EK.397,EK.398, EK.389,EK.390	5120.74
154	1-A2	EK.399,EK.400,EK.401,EK.402, EK.403,EK.404,EK.405,EK.406, EK.407	5889.24
154	1-A3	EK.410,EK.411,EK.408,EK.409	1439.15

NoktaNo	Y	X	NoktaNo	Y	X
EK.389	634895.92	4084736.02	EK.390	634900.65	4084736.25
EK.391	634905.99	4084736.95	EK.392	634951.84	4084719.10
EK.393	634999.99	4084711.55	EK.394	635008.87	4084693.69
EK.395	635022.35	4084664.48	EK.396	635032.94	4084637.82
EK.397	634946.66	4084677.84	EK.398	634923.60	4084695.59
EK.399	635007.12	4084710.69	EK.400	635077.26	4084704.65
EK.401	635118.84	4084639.87	EK.402	635104.66	4084640.00
EK.403	635084.26	4084614.01	EK.404	635040.33	4084634.39
EK.405	635040.07	4084636.13	EK.406	635027.86	4084666.84
EK.407	635014.29	4084696.29	EK.408	635089.85	4084611.42
EK.409	635107.56	4084633.97	EK.410	635122.71	4084633.83
EK.411	635157.14	4084580.20			

RÖLEVE KROKİSİ

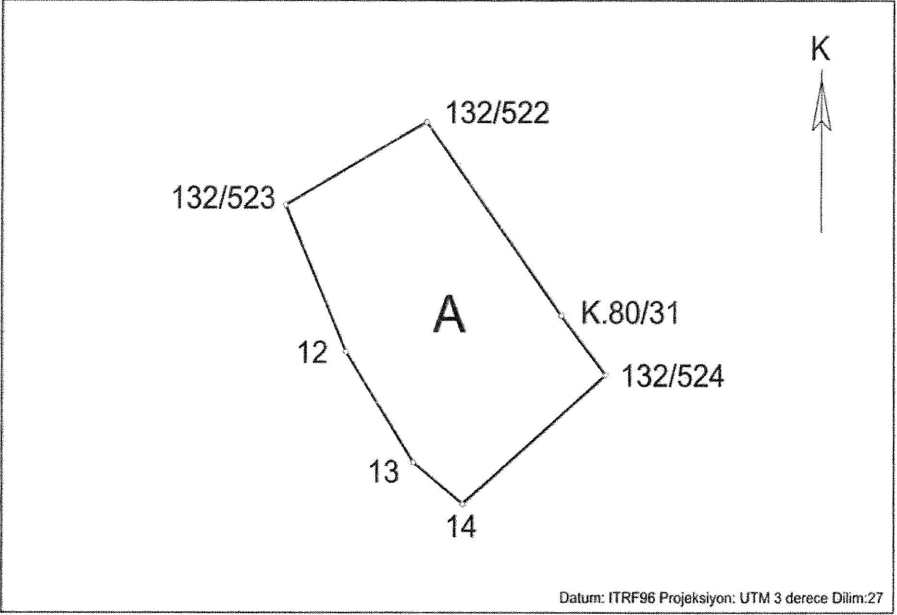

Ada	Parsel	Noktalar	HesapAlan
138	1-A	132/523,132/522,K.80/31, 132/524,14,13,12	295.96

NoktaNo	Y	X	NoktaNo	Y	X
12	555955.06	4106195.25	13	555959.87	4106187.97
14	555963.37	4106185.21	132/522	555960.77	4106210.36
132/523	555950.68	4106204.91	132/524	555973.56	4106193.72
K.80/31	555970.39	4106197.61			

RÖLEVE KROKİSİ

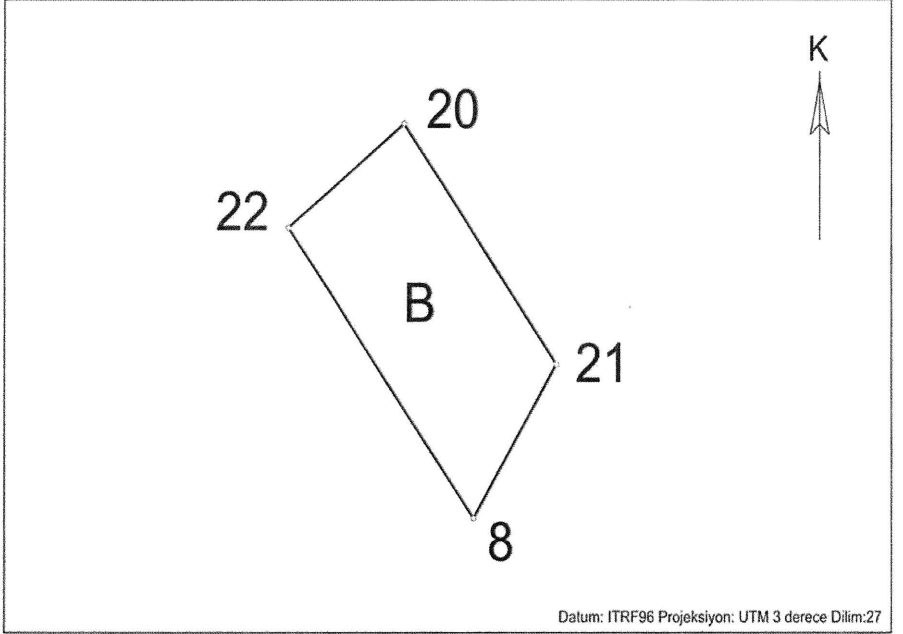

Ada	Parsel	Noktalar	HesapAlan
A		8,22,20,21	221.09

NoktaNo	Y	X	NoktaNo	Y	X
8	556525.23	4107012.21	20	556520.20	4107037.39
21	556531.18	4107022.05	22	556511.88	4107030.73

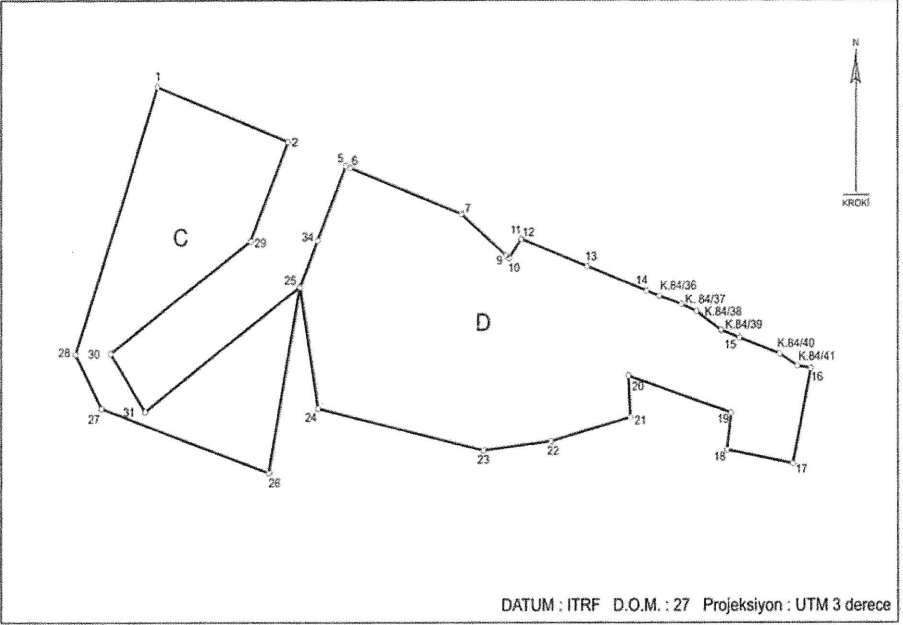

NoktaNo	Y	X	NoktaNo	Y	X
1	556967.48	4106838.80	2	556993.15	4106829.45
5	557004.45	4106825.33	6	557005.35	4106825.00
7	557027.15	4106817.06	9	557035.93	4106809.90
10	557036.46	4106809.46	11	557038.83	4106812.76
12	557038.85	4106812.79	13	557051.80	4106808.07
14	557063.51	4106803.81	15	557081.78	4106795.74
16	557095.63	4106790.52	17	557092.15	4106774.35
18	557079.34	4106776.70	19	557080.15	4106783.02
20	557059.94	4106789.31	21	557060.34	4106782.29
22	557044.67	4106778.25	23	557031.45	4106776.66
24	556999.01	4106783.83	25	556995.45	4106804.55
26	556989.33	4106772.84	27	556956.42	4106783.85
28	556951.32	4106793.03	29	556985.79	4106812.45
30	556958.16	4106793.17	31	556965.03	4106783.32
34	556998.93	4106812.58	K.84/36	557066.01	4106802.90
K. 84/37	557070.49	4106801.49	K.84/38	557073.42	4106800.27
K.84/39	557078.14	4106797.04	K.84/40	557089.60	4106792.97
K.84/41	557093.05	4106790.92			

Ada	Parsel	Noktalar	HesapAlan
138	1-C	1,2,29,30,31,25,26,27,28	1476.84
138	1-D	9,10,11,12,13,14,K.84/36, K. 84/37,K.84/38,K.84/39,15, K.84/40,K.84/41,16,17,18,19, 20,21,22,23,24,25,34,5,6,7	2776.60

İli : Muğla  
İlçesi : Yatağan  
Köy/Mahalle : Kafacakplancık

### RÖLEVE KROKİSİ

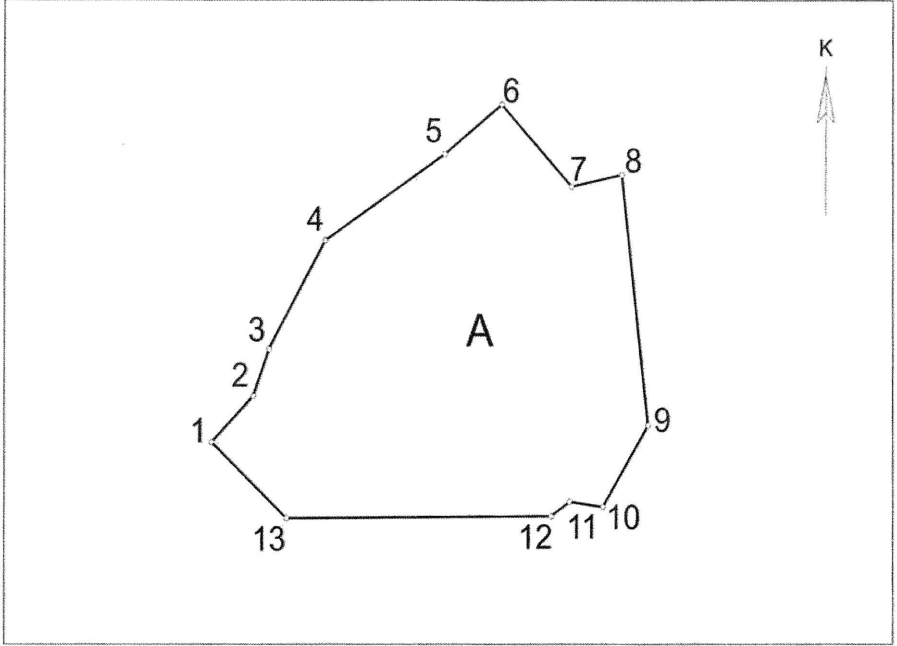

DATUM : ITRF D.O.M. : 27 Projeksiyon : UTM 3 derece

Ada	Parsel	Noktalar	HesapAlan
195	1-A	12,13,1,2,3,4,5,6,7,8,9,10,11	806285.83

NoktaNo	Y	X	NoktaNo	Y	X
1	602749.70	4139658.63	2	602863.23	4139772.16
3	602905.43	4139886.70	4	603058.14	4140151.95
5	603381.18	4140363.98	6	603535.17	4140485.21
7	603722.81	4140283.96	8	603857.89	4140312.72
9	603928.96	4139699.74	10	603808.00	4139500.73
11	603717.95	4139513.23	12	603669.11	4139478.23
13	602953.66	4139472.76			

## RÖLEVE KROKİSİ

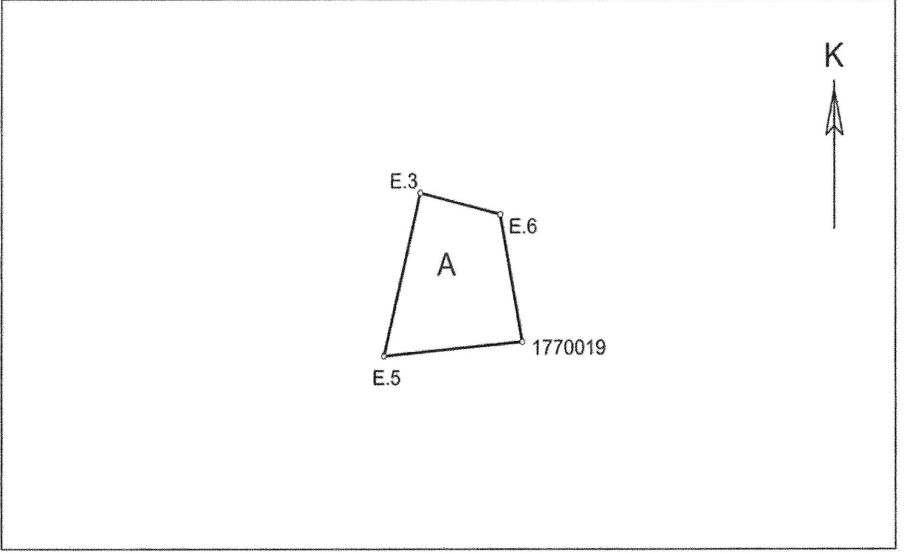

Ada	Parsel	Noktalar	HesapAlan
177	1-A	E.3,E.6,1770019,E.5	75.70

NoktaNo	Y	X	NoktaNo	Y	X
1770019	547790.52	4513788.21	E.6	547788.91	4513796.52
E.3	547783.10	4513797.93	E.5	547780.40	4513787.27

RÖLEVE KROKİSİ

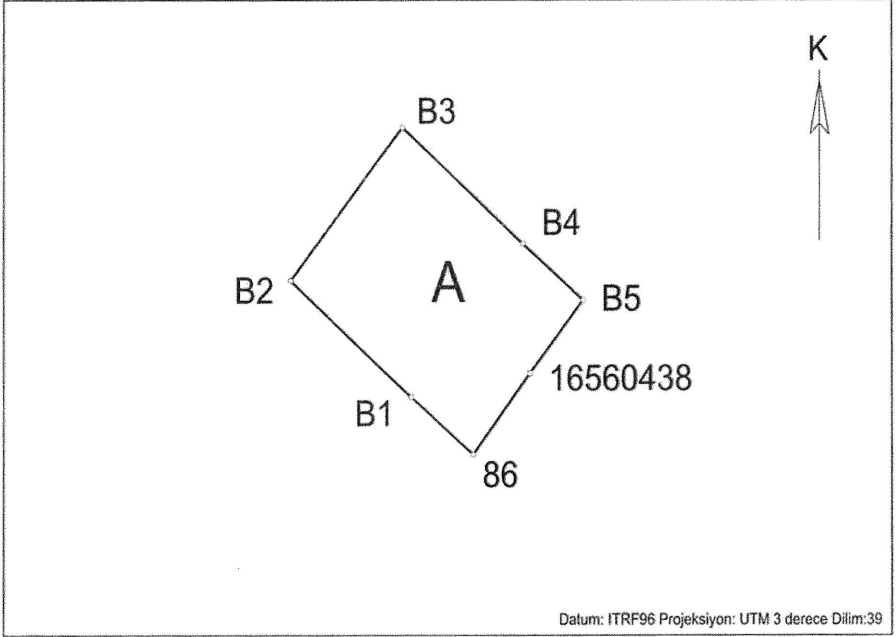

Ada	Parsel	Noktalar	HesapAlan
1656	105-A	B1,B2,B3,B4,B5,16560438,86	124.86

NoktaNo	Y	X	NoktaNo	Y	X
86	557544.45	4521901.76	16560438	557547.56	4521905.71
B1	557541.04	4521904.55	B2	557534.45	4521910.18
B3	557540.57	4521917.59	B4	557547.16	4521911.96
B5	557550.50	4521909.23			

İli : ZONGULDAK  
İlçesi : KOZLU  
Köyü : ESENKÖY

## RÖLEVE KROKİSİ

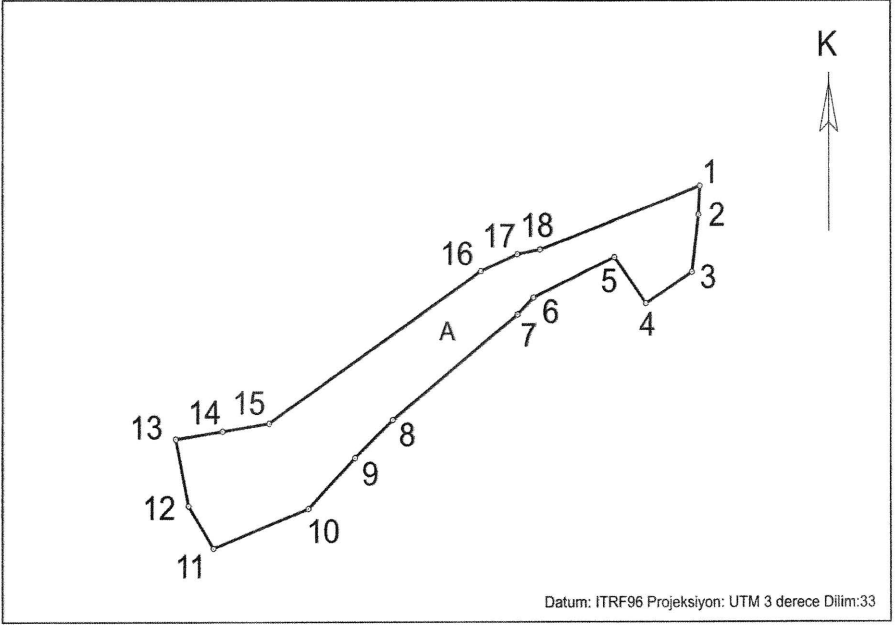

Ada	Parsel	Noktalar	HesapAlan
159	1-A	1,2,3,4,5,6,7,8,9,10,11,12,13, 14,15,16,17,18	2017.68

NoktaNo	Y	X	NoktaNo	Y	X
1	390655.25	4586965.14	2	390654.94	4586959.14
3	390653.38	4586947.14	4	390642.66	4586940.57
5	390635.30	4586950.27	6	390616.64	4586941.79
7	390612.99	4586938.23	8	390583.97	4586916.26
9	390575.32	4586908.35	10	390564.57	4586897.68
11	390542.48	4586889.36	12	390536.68	4586898.24
13	390533.71	4586912.22	14	390544.59	4586913.88
15	390555.50	4586915.55	16	390604.45	4586947.29
17	390612.92	4586950.88	18	390618.19	4586951.86